

I Mina'Trentai Kuáttro Na Liheslaturan
BILL STATUS

BILL NO.	SPONSOR	TITLE	DATE INTRODUCED	DATE REFERRED	CMTE REFERRED	PUBLIC HEARING DATE	DATE COMMITTEE REPORT FILED	FISCAL NOTES	NOTES
331-34 (COR)	FRANK B. AGUON, JR.	AN ACT RELATIVE TO APPROVING THE ARCHITECTURAL AND ENGINEERING DESIGN FOR THE REHABILITATION AND IMPROVEMENT OF THE HARMON INDUSTRIAL PARK ROADWAY, PER ARTICLE 7 OF CHAPTER 77, TITLE 12, GUAM CODE ANNOTATED.	7/23/18 10:13 a.m.						

I MINA' TRENTAI KUATTRO NA LIHESLATURAN GUÅHAN
2018 (SECOND) Regular Session

Bill No. 331-34 (COR)

Introduced by:

FRANK B. AGUON, JR.



AN ACT RELATIVE TO APPROVING THE ARCHITECTURAL AND ENGINEERING DESIGN FOR THE REHABILITATION AND IMPROVEMENT OF THE HARMON INDUSTRIAL PARK ROADWAY, PER ARTICLE 7 OF CHAPTER 77, TITLE 12, GUAM CODE ANNOTATED.

2018 JUL 23 AM 10:13

1 **BE IT ENACTED BY THE PEOPLE OF GUAM:**

2 **Section 1. Legislative Findings and Intent.**

3 *I Liheslaturan Guåhan* finds that through the passage of Public Law No. 33-191
4 a public-private partnership was established between the Government of Guam and
5 the Harmon Industrial Park Association (HIPA) to realize the rehabilitation and
6 improvement of the Harmon Industrial Park roadway. The repair of these roads are
7 necessary to address the significant flooding problems experienced by individuals who
8 traverse these roads during the rainy season, and to address the worsening and unsafe
9 condition of the roads that have contributed to damaged tires and occasionally have
10 lead to vehicular accidents. *I Liheslaturan Guåhan* further finds that HIPA members
11 were required by the aforementioned legislation to submit the Architectural and
12 Engineering design for the project, with the guidance and oversight of the Department
13 of Public Works, to the Speaker of *I Liheslaturan Guåhan*, a requirement which has
14 since been complied with in accordance with established timelines. The Harmon
15 Industrial Park area serves as an integral part of Guam's economic business sector,
16 wherein over thirty-six (36) businesses are located that employ more than 4000

1 employees; thus it is essential that this roadway repair and upgrade commence
2 immediately.

3 Therefore, it is the intent of *I Liheslaturan Guåhan* to accept the Architectural
4 and Engineering design submitted to the Speaker of *I Mina Trentai Kuåttro Na*
5 *Liheslaturan Guåhan* in accordance with the requirements set forth within Public Law
6 No. 33-191, as amended by Public Law No. 34-10, which will allow for the
7 rehabilitation and improvement of the Harmon Industrial Park roadway.

8 **Section 2. Approval of the Architectural and Engineering Design for the**
9 **rehabilitation and improvement of the Harmon Industrial Park Roadway.**

10 In accordance with 12 GCA § 77710, the Architectural and Engineering
11 ("A&E") Design for the rehabilitation and improvement of the Harmon Industrial Park
12 roadway submitted by the Harmon Industrial Park Association to the Speaker of *I*
13 *Liheslaturan Guåhan* on April 27, 2018 (attached hereto as "Exhibit A") is hereby
14 approved.

15 **Section 3. Effective Date.**

16 This Act shall be effective upon enactment.

EXHIBIT A

**Frank Shimizu President
Harmon Industrial Park Association
124 Chalan Achote
Tamuning, GU 96913**

April 24, 2018

**Honorable Speaker Benjamin J.F. Cruz
I Mina'trentai Kuattro Na Liheslaturan Guahan
163 Chalan Santo Papa
Hagatna, Guam 96910**

Dear Speaker Cruz;

Enclosed herewith, as required by Public Law 33-191 and subsequently by Public Law 34-10, are the Architectural and Engineering (A&E) Designs for the rehabilitation and improvements of the Harmon Industrial Park Roadway project. PL 34-10 stipulates that no tax credits shall be applied for, or approved, until the completion of the A&E, and identified the submittal to be no later than May 1, 2018. We have also included both PL 33-191 and PL 34-10 for your reference.

The attached A&E identifies all the projects of the Harmon Industrial Park Roadway that will be rehabilitated and improved, which is within the total cost of \$3,700,000 that was identified in both PL 33-191 and PL 34-10. We have also identified the total expenditures of the A&E which amounts to \$300,000, which was stipulated in the two public laws.

The Harmon Industrial Park Association (HIPA) will be taking the next steps of this public law by issuing a Request for Proposal for the initiation of the projects and the application of specific tax credits related to what was noted in PL 34-10. We thank the Guam Legislature for their support in improving the Harmon Industrial Park Roadway, which will be beneficial for island residents.

Sincerely,

Frank Shimizu

**CC: Senator Frank Aguon
Guam Economic Development Agency**

I Mina'Trentai Tres Na Liheslaturan Received
 Bill Log Sheet

BILL NO.	SPONSOR	TITLE	DATE INTRODUCED	DATE REFERRED	CMTE REFERRED	PUBLIC HEARING DATE	DATE COMMITTEE REPORT FILED	ISCA NOTES
PUBLIC LAW 33-191 285-33 (COR)	FRANK B. AGUON, JR	AN ACT TO ADD A NEW ARTICLE 7 TO CHAPTER 77, DIVISION 2, TITLE 12, GUAM CODE ANNOTATED, RELATIVE TO TAX CREDITS FOR THE REHABILITATION AND IMPROVEMENT OF THE HARMON INDUSTRIAL PARK ROADWAY.	03/29/16 8:51 a.m.	03/31/16	Committee on Finance and Taxation, General Government Operations and Youth Development	09/30/16 3:00 p.m.	11/22/16 4:33 p.m.	Fiscal Note Request 04/01/16 Fiscal Note 06/15/16
	DATE PASSED	TITLE	DATE AND TIME TRANSMITTED		DUE DATE	DATE COMMITTEE REPORT FILED	PUBLIC LAW NO.	NOTES
	12/03/16	AN ACT TO ADD A NEW ARTICLE 7 TO CHAPTER 77, DIVISION 2, TITLE 12, GUAM CODE ANNOTATED, RELATIVE TO AUTHORIZING CERTAIN BUSINESS PRIVILEGE TAX CREDITS AND USE EXCISE TAX CREDITS FOR THE REHABILITATION AND IMPROVEMENT OF THE HARMON INDUSTRIAL PARK ROADWAY.	12/05/16	4:50 p.m.	12/16/16	12/13/16	33-191	PARC No. R3GL-16-2256

April 27, 2018

Harmon Industrial Park Association
c/o Ambros Inc.
124 Chalan Achote
Harmon Industrial Park
Tamuning, GU 96913

Attn: Mr. Frank Shimizu, President

**Subject: Harmon Industrial Park Roadway
Rehabilitation and Improvement
Design Projects**

Hafa Adai Frank,

TG Engineers, PC, in cooperation with the Harmon Industrial Park Association, has identified the list of design projects, including the total estimated cost, that would qualify under the tax credits of Public Law 34-10. We are submitting today with the intent of HIPA making the submittal for Legislative Approval on schedule, by May 01, 2018.

DESIGN PROJECTS

- **Ilipog Drive Rehabilitation and Improvement** - This project provides for the improvement of Ilipog Drive, from the Route 1/GTA intersection to the Harmon Industrial Park Roadway, by widening the existing 2-lane roadway to a 4-lane roadway to provide safety and increased capacity. This work includes erosion control, grading, surfacing, paving, striping, utility adjustment, and traffic control.
- **Harmon Industrial Park Roadway (Siket Ln to Old Flea Market)** - This project provides for the improvement of approximately 4,830 linear feet of Harmon Industrial Park Roadway, from Siket Ln to the Old Flea Market road, by widening the existing 2-lane roadway to a 3-lane roadway with a center turning lane. This work includes erosion control, grading, surfacing, paving, striping, utility adjustment, and traffic control.
- **Harmon Industrial Park Roadway to the DPW Hamburger Hwy Pavement Limit** - This project provides for the improvement of approximately 475 linear feet of new road construction from the Harmon Industrial Park Roadway to Hamburger Highway. This work includes erosion control, grading, surfacing, paving, striping, utility adjustment, and traffic control.

ESTIMATED COST

Architectural and Engineering Design:	\$ 300,000
Construction Management:	\$ 397,000
Construction Cost:	\$3,303,000
Total Cost	\$4,000,000

Please note the Architectural and Engineering design fee and the \$4 million total budget from P.L. 34-10 are incorporated in the budget summary.

We look forward to continue the collaborative working relationship with the HIPA. Should you have any questions, please don't hesitate to contact Jack Edward or myself at 647-0808 or via email at jacke@tg-engr.com or torg@tg-engr.com.

Si Yu'os Ma'ase,



Tor Gudmundsen, PE
TG Engineers, PC
President

Attachments: Design Project Drawing

Cc (via email): Leonard Kaae
Monty McDowell
Bobby Shringi

HARMON INDUSTRIAL PARK ROADWAY REHABILITATION AND IMPROVEMENT DESIGN PROJECTS HARMON, GUAM

LOCATION MAP

VICINITY MAP

SHEET INDEX

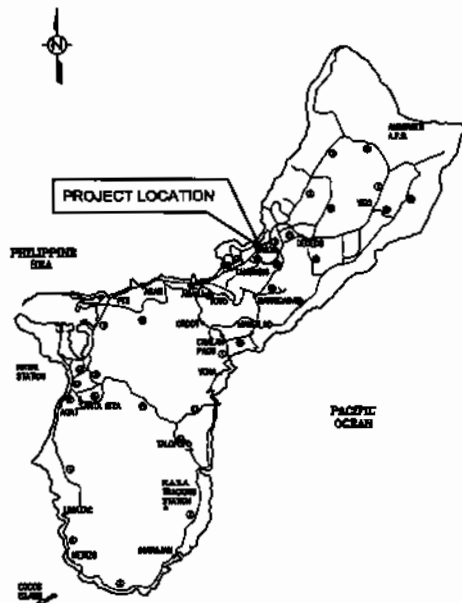

KEY MAP OF GUAM
scale: nts

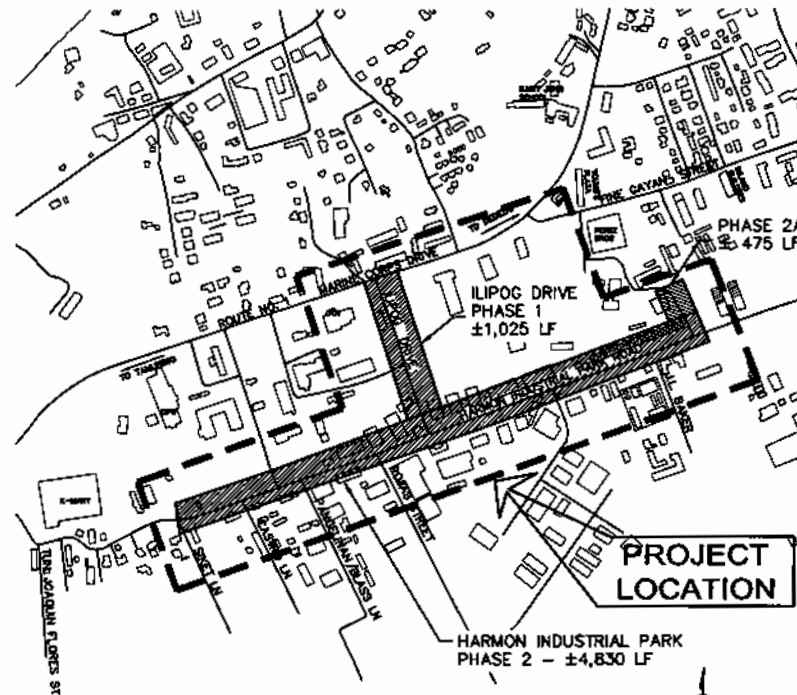

VICINITY MAP
SCALE: NTS

SHEET NO.	DWG. REF. NO.	TITLE
1 OF 19	T100	TITLE SHEET, LOCATION MAP AND MONITY MAP
2 OF 19	T101	KEYPLAN
3 OF 19	T102	GENERAL NOTES
4 OF 19	T103	SUMMARY OF QUANTITIES
5 OF 19	C000	EXISTING SITE AND SURVEY PLAN
6 OF 19	C010	ALIGNMENT PLAN /DATA
7 OF 19	C020	TYPICAL ROAD SECTIONS
8 OF 19	C021	TYPICAL ROAD SECTIONS
9 OF 19	C101	PHASE 1 ILIOG DRIVE IMPROVEMENT
10 OF 19	C102	PHASE 1 ILIOG DRIVE IMPROVEMENT
11 OF 19	C201	PHASE 2 HARMON INDUSTRIAL ROAD IMPROVEMENT
12 OF 19	C202	PHASE 2 HARMON INDUSTRIAL ROAD IMPROVEMENT
13 OF 19	C203	PHASE 2 HARMON INDUSTRIAL ROAD IMPROVEMENT
14 OF 19	C204	PHASE 2 HARMON INDUSTRIAL ROAD IMPROVEMENT
15 OF 19	C205	PHASE 2 HARMON INDUSTRIAL ROAD IMPROVEMENT
16 OF 19	C206	PHASE 2 HARMON INDUSTRIAL ROAD IMPROVEMENT
17 OF 19	C207	PHASE 2 HARMON INDUSTRIAL ROAD IMPROVEMENT
18 OF 19	C208	PHASE 2 HARMON INDUSTRIAL ROAD IMPROVEMENT
19 OF 19	C301	PHASE 2A HARMON INDUSTRIAL ROAD TO HAMBURGER HIGHWAY

DPW STD. NO.	DPW STANDARD DRAWINGS
157-01	SILT FENCE DETAILS
157-02	TEMPORARY CURB INLET PROTECTION
403-01	ASPHALT PAVEMENT OVERLAY TRANSITIONS
604-09	MANHOLE COVER, FRAME, & CONCRETE COLLAR
633-01	ROADSIDE SIGN INSTALLATION
634-01	PAVEMENT MARKINGS AND DIRECTIONAL ARROW
634-02	2-LANE PAVEMENT MARKING
634-03	MULTI-LANE PAVEMENT MARKING
634-04	INTERSECTION PAVEMENT MARKING
635-01	CHANNELIZING DEVICES AND BARRICADES
635-02	LANE CLOSURE ON TWO LANE HIGHWAY

DRAWING REVISIONS			
REVISION	DATE	BY	DESCRIPTION

DESIGNER	JE
DRAWN	RJ
CHECKER	TC/JE
DATE	MAY 01, 2018

TG ENGINEERS, PC
CIVIL ENGINEERING, PLANNING, CONSTRUCTION,
MANAGEMENT & LAND SURVEYING

HARMON INDUSTRIAL PARK ROADWAY
REHABILITATION AND IMPROVEMENT
DESIGN PROJECTS
TITLE SHEET

GUAM DEPARTMENT OF PUBLIC WORKS				
W/LAKE	TERRITORY	PROJECT	DRAWING	SHEET NO.
	GUAM	HPA	T100	

This work was prepared by me or under my responsible control.

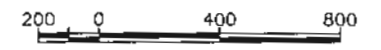
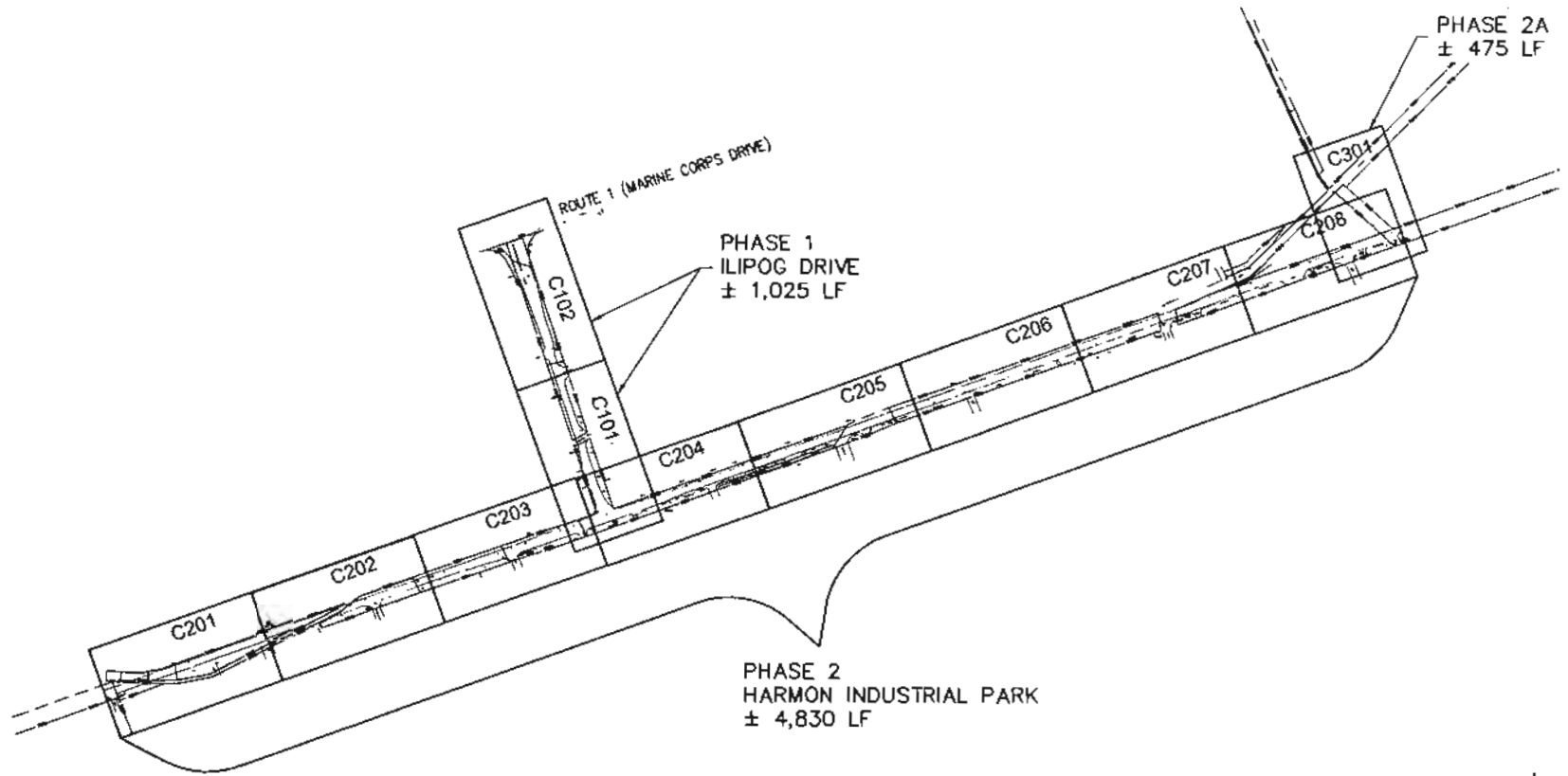

DRAWING REVISIONS				DESIGNER	 CIVIL ENGINEERING, PLANNING, CONSTRUCTION MANAGEMENT & LAND SURVEYING	HARMON INDUSTRIAL PARK ROADWAY REHABILITATION AND IMPROVEMENT DESIGN PROJECTS		GUAM DEPARTMENT OF PUBLIC WORKS						
REVISION	DATE	BY	DESCRIPTION	DETAILER		KEYMAP		VILLAGE	TERRITORY	PROJECT	DRAWING	SHEET	TOTAL	
									TITIAN	GUAM	HIPA	T101	1	
				CHECKER										
				DATE										

This work was prepared by me
or under my professional control

SUMMARY OF QUANTITIES

STD ITEM NO.	ITEM DESCRIPTION	UNIT	TOTAL QUANTITY	GROUPS		
				ILIPOG DRIVE	PHASE 2 - HARMON INDUSTRIAL PARK ROAD	PHASE 2A - HARMON INDUSTRIAL PARK TO HAMBURGER HIGHWAY
15101-0000	MOBILIZATION	LPSM	ALL	LPSM	LPSM	LPSM
15201-0000	CONSTRUCTION SURVEY AND STAKING	LPSM	ALL	LPSM	LPSM	LPSM
15401-0000	CONTRACTOR TESTING	LPSM	ALL	LPSM	LPSM	LPSM
15501-0000	CONSTRUCTION SCHEDULE	LPSM	ALL	LPSM	LPSM	LPSM
15701-0100	SOIL EROSION CONTROL	LPSM	ALL	LPSM	LPSM	LPSM
15801-0000	WATERING FOR DUST CONTROL	MGAL	80	15	35	15
20315-0000	SAWCUTTING PAVEMENT	LNFT	8,415	367	6,204	44
20401-0000	ROADWAY EXCAVATION INCL HAUL	CUYD	3,169	106	1,992	704
30102-0300	AGGREGATE BASE, 8-INCH DEPTH	SQYD	8,225	367	5,983	774
30107-0000	SUBBASE, 8-INCH DEPTH	CUYD	1,903	71	1,330	258
40201-XXXX	ASPHALT CONCRETE PAVEMENT, 2-INCH DEPTH	TON	2,991	321	2,139	132
40201-1010	HOT MIX ASPHALT (HMA) CONCRETE FRICTION COURSE, 1-INCH DEPTH	SQYD	2,564	2,564	0	0
41301-0000	ASPHALT PAVEMENT MILLING, 2" DEPTH	SQYD	16,720	1,520	12,800	0
41301-0200	ASPHALT PAVEMENT MILLING, 1" DEPTH	SQYD	2,564	2,564	0	0
61208-XXXX	ADJUST UTILITY COVER WITH CONCRETE COLLAR	EACH	54	6	38	2
63301-0009	SIGN SYSTEM (36" X 36") - STOP SIGN	EACH	13	1	9	1
63301-XXXX	SIGN SYSTEM (STREET SIGN)	EACH	10	0	7	1
63401-1501	PAVEMENT MARKINGS, TYPE H, 4-INCH WIDE SOLID LINE, WHITE	LNFT	13,612	2,152	9,660	0
63401-1503	PAVEMENT MARKINGS, TYPE H, 4-INCH WIDE SOLID LINE, YELLOW	LNFT	14,034	1,624	9,660	950
63401-1506	PAVEMENT MARKINGS, TYPE H, CROSSWALK/STOP, 12-INCH WIDE SOLID LINE, WHITE	LNFT	862	192	634	12
63401-1601	PAVEMENT MARKINGS, TYPE H, 4-INCH WIDE, BROKEN LINE, YELLOW	LNFT	10,180	0	8,380	0
63401-1602	PAVEMENT MARKINGS, TYPE H, 4-INCH WIDE, BROKEN LINE, WHITE	LNFT	1,752	1,752	0	0
63405-2900	PAVEMENT MARKINGS, TYPE H, TURN ARROW	EACH	42	12	22	4
63405-2950	PAVEMENT MARKINGS, TYPE H, STRAIGHT ARROW	EACH	30	0	22	4
63405-3000	PAVEMENT MARKINGS, TYPE H, STRAIGHT/TURN ARROW COMBINATION	EACH	3	3	0	0
63406-0201	RAISED PAVEMENT MARKER, REFLECTORIZED 2-WAY, TYPE "YY"	EACH	2,335	147	1,731	119
63406-02XX	RAISED PAVEMENT MARKER, REFLECTORIZED 2-WAY, TYPE "CR"	EACH	55	55	0	0
63406-02XX	RAISED PAVEMENT MARKER, REFLECTORIZED 2-WAY, TYPE "BB"	EACH	9	2	5	0
63501-0000	TEMPORARY TRAFFIC CONTROL	LPSM	ALL	LPSM	LPSM	LPSM
63701-0100	FIELD OFFICE	LPSM	ALL	LPSM	LPSM	LPSM

<table border="1" style="width: 100%; border-collapse: collapse;"> <thead> <tr> <th colspan="3">DRAWING REVISIONS</th> </tr> <tr> <th>REVISION</th> <th>DATE</th> <th>BY</th> </tr> </thead> <tbody> <tr><td> </td><td> </td><td> </td></tr> <tr><td> </td><td> </td><td> </td></tr> <tr><td> </td><td> </td><td> </td></tr> <tr><td> </td><td> </td><td> </td></tr> </tbody> </table>	DRAWING REVISIONS			REVISION	DATE	BY													<table border="1" style="width: 100%; border-collapse: collapse;"> <tr><td>DESIGNER</td><td>JE</td></tr> <tr><td>DRAWER</td><td>RJ</td></tr> <tr><td>CHECKER</td><td>TG/JE</td></tr> <tr><td>DATE</td><td>MAY 01, 2018</td></tr> </table>	DESIGNER	JE	DRAWER	RJ	CHECKER	TG/JE	DATE	MAY 01, 2018	<p style="font-size: small; margin: 0;">CIVIL ENGINEERING, PLANNING, CONSTRUCTION MANAGEMENT & LAND SURVEYING</p>	<p>HARMON INDUSTRIAL PARK ROADWAY REHABILITATION AND IMPROVEMENT DESIGN PROJECTS</p> <p>SUMMARY OF QUANTITIES</p>	<p>GUAM DEPARTMENT OF PUBLIC WORKS</p> <table border="1" style="width: 100%; border-collapse: collapse; font-size: x-small;"> <tr> <th>VILLAGE</th> <th>TERRITORY</th> <th>PROJECT</th> <th>GROUPING</th> <th>SHEET NO.</th> <th>TOTAL NO.</th> </tr> <tr> <td>TITIAN</td> <td>GUAM</td> <td>HIPA</td> <td>T103</td> <td>1</td> <td> </td> </tr> </table>	VILLAGE	TERRITORY	PROJECT	GROUPING	SHEET NO.	TOTAL NO.	TITIAN	GUAM	HIPA	T103	1	
DRAWING REVISIONS																																										
REVISION	DATE	BY																																								
DESIGNER	JE																																									
DRAWER	RJ																																									
CHECKER	TG/JE																																									
DATE	MAY 01, 2018																																									
VILLAGE	TERRITORY	PROJECT	GROUPING	SHEET NO.	TOTAL NO.																																					
TITIAN	GUAM	HIPA	T103	1																																						

This work was prepared by me or under my responsible control

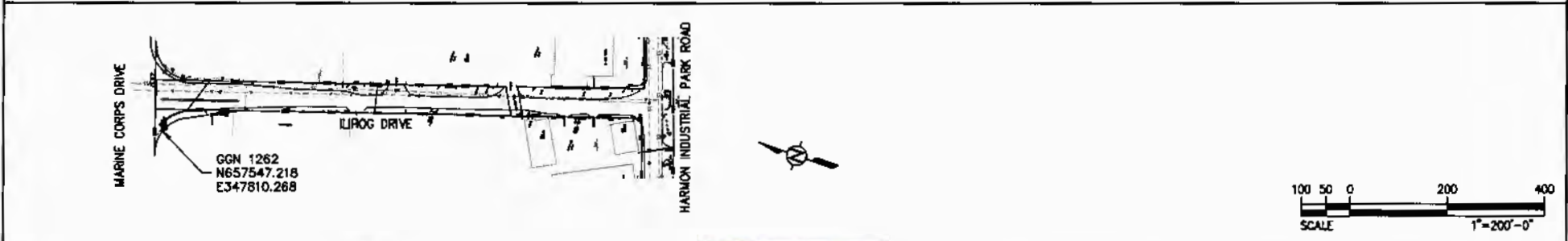
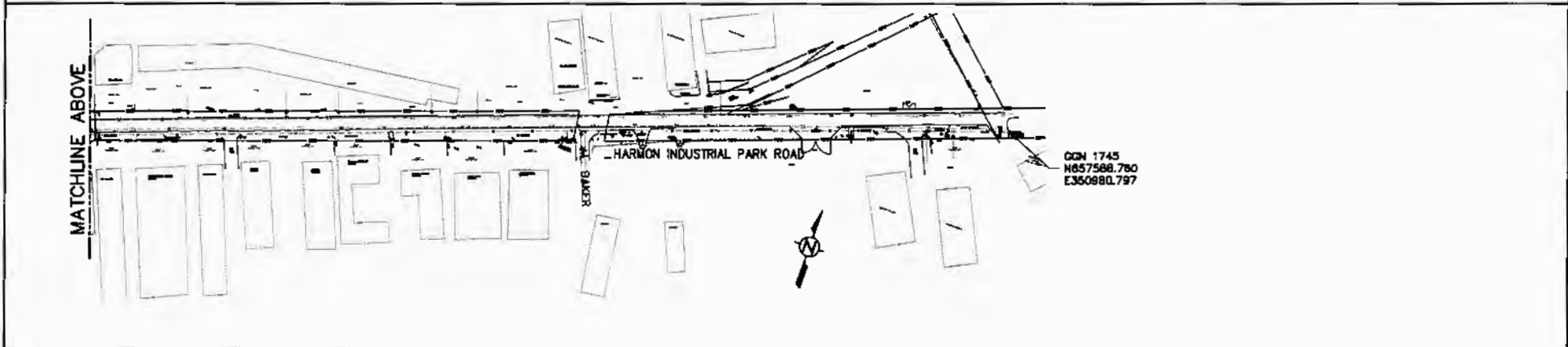
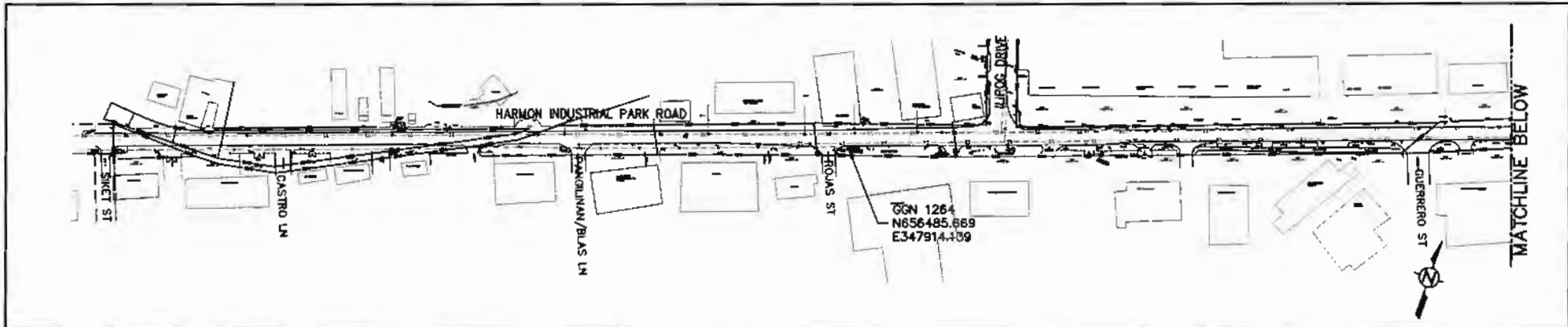

DRAWING REVISIONS		
REVISION	DATE	BY

DESIGNER
JE

CHECKER
TG/JE

DATE
MAY 01, 2018

TG ENGINEERS, PC
CIVIL ENGINEERING, PLANNING, CONSTRUCTION
MANAGEMENT & LAND SURVEYING

HARMON INDUSTRIAL PARK ROADWAY
REHABILITATION AND IMPROVEMENT
DESIGN PROJECTS

EXISTING SITE AND SURVEY PLAN

GUAM DEPARTMENT OF PUBLIC WORKS					
VILLAGE	TERRITORY	PROJECT	DRAWING	SHEET NO.	TOTAL SHEETS
TIYAN	GUAM	HPA	C000	1	

This work was prepared by me or under my responsible control

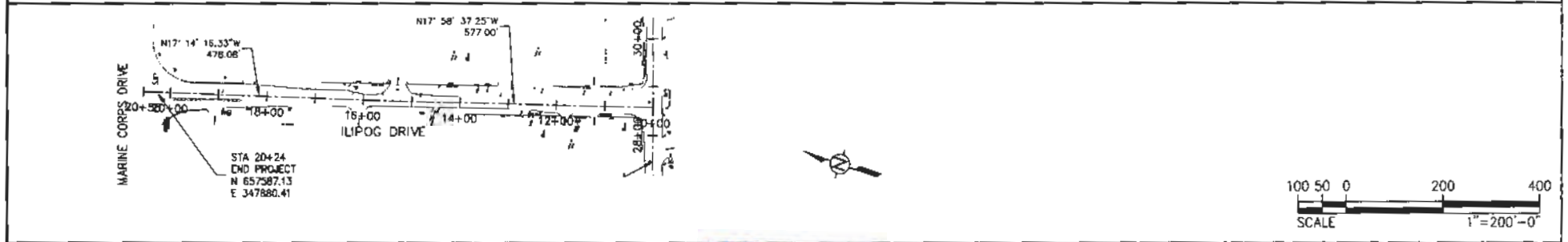
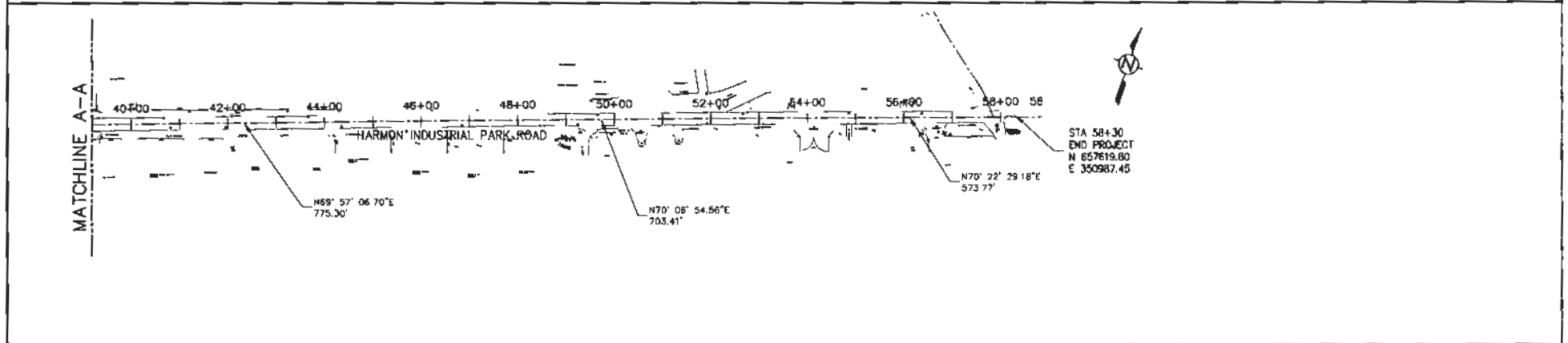
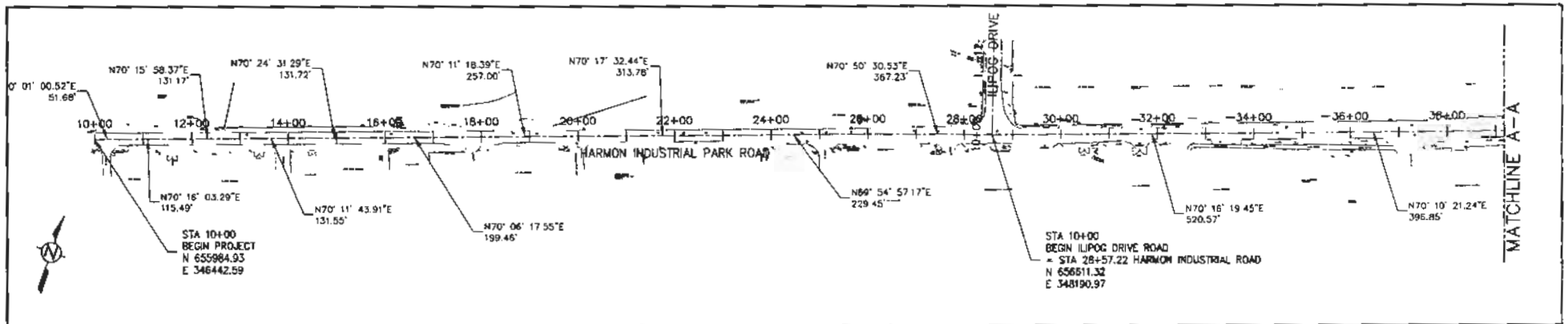

DRAWING REVISIONS				DESIGNER	 OWN ENGINEERING, PLANNING, CONSTRUCTION MANAGEMENT & LAND SURVEYING	GUAM DEPARTMENT OF PUBLIC WORKS					
REVISION	DATE	BY	DESCRIPTION	DEVELOPER		VILLAGE	TERRITORY	PROJECT	DRAWING NO.	SHEET NO.	TOTAL NO.
				RJ		TIYAN	GUAM	HPA	C040	1	
				TG/JE							

DESIGNER: JE
DEVELOPER: RJ
CHECKER: TG/JE
DATE: MAY 01, 2018

HARMON INDUSTRIAL PARK ROADWAY
REHABILITATION AND IMPROVEMENT
DESIGN PROJECTS
ALIGNMENT PLAN AND DATA

This work was prepared by me
or under my responsible control

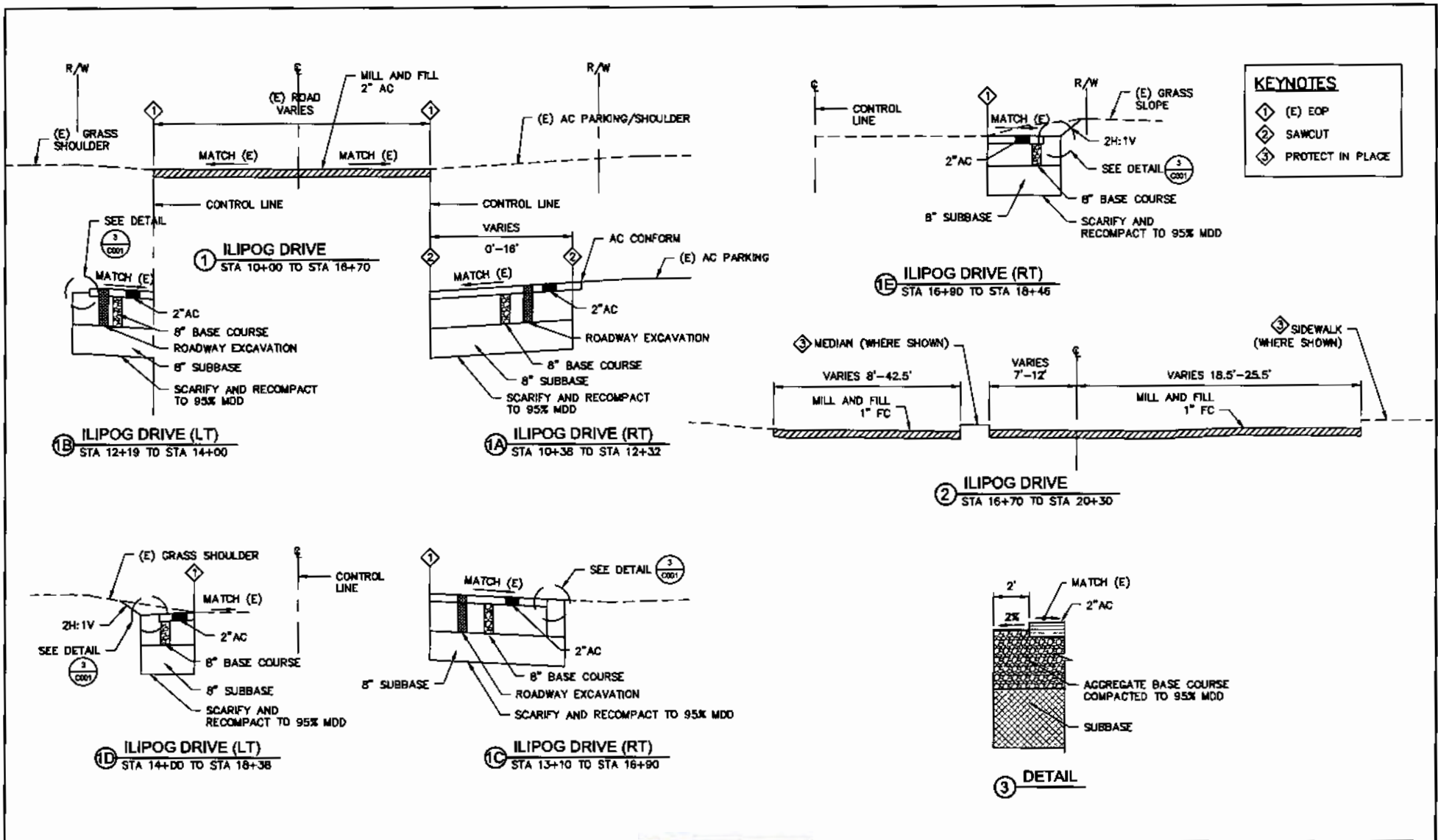

KEYNOTES	
①	(E) EOP
②	SAWCUT
③	PROTECT IN PLACE

This work was prepared by me or under my responsible control

DRAWING REVISIONS			
REVISION	DATE	BY	DESCRIPTION

DESIGNER JE
 CHECKER RJ
 DRAFTER TS/JE
 DATE MAY 01, 2018

TG ENGINEERS, PC
 CIVIL ENGINEERING, PLANNING, CONSTRUCTION
 MANAGEMENT & LAND SURVEYING

HARMON INDUSTRIAL PARK ROADWAY
 REHABILITATION AND IMPROVEMENT
 DESIGN PROJECTS
 TYPICAL ROADWAY SECTIONS

GUAM DEPARTMENT OF PUBLIC WORKS					
RELAY	TERRITORY	PROJECT	DRAWING	SHEET NO.	TOTAL NO.
TIYAN	GUAM	HFA	C020	1	

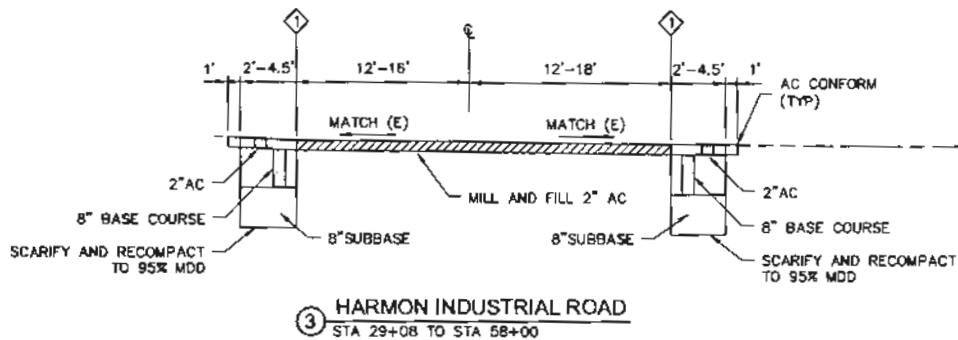
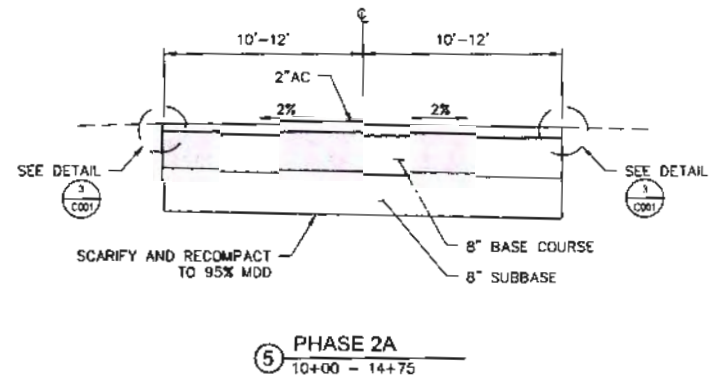
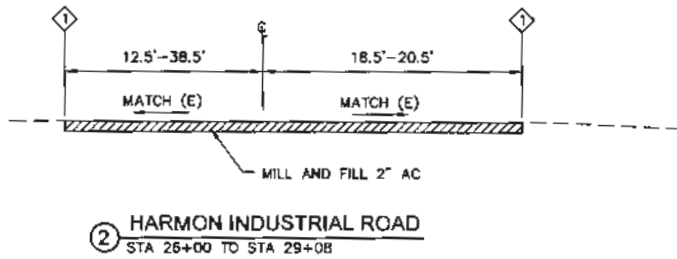
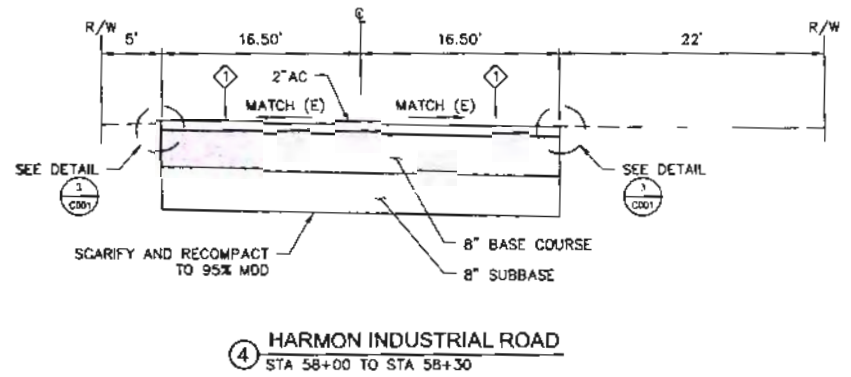
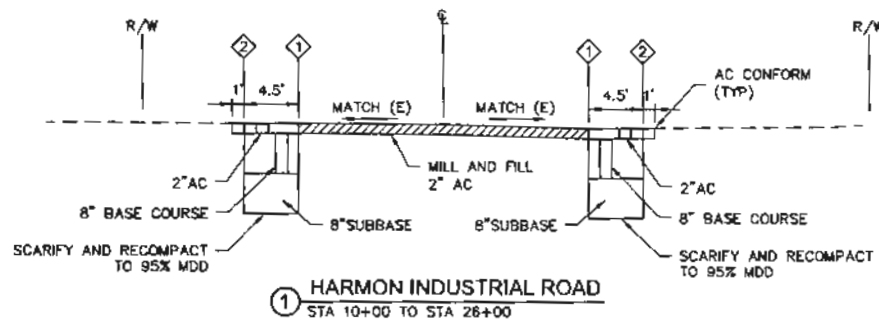

DRAWING REVISIONS		
REVISION	DATE	BY

DESIGNER	JE
DEVELOPER	RJ
CHECKER	TC/JE
DATE	MAY 01, 2018

TG ENGINEERS, PC
 CIVIL, ENVIRONMENTAL, PLANNING, CONSTRUCTION
 MANAGEMENT & LAND SURVEYING

HARMON INDUSTRIAL PARK ROADWAY
 REHABILITATION AND IMPROVEMENT
 DESIGN PROJECTS
 TYPICAL ROADWAY SECTIONS

GUAM
 DEPARTMENT OF PUBLIC WORKS

MUNICIPALITY	TERRITORY	PROJECT	DRAWING	SHEET NO.	TOTAL NO.
TIYAN	GUAM	HPA	C021	1	

This work was prepared by me or under my responsible control

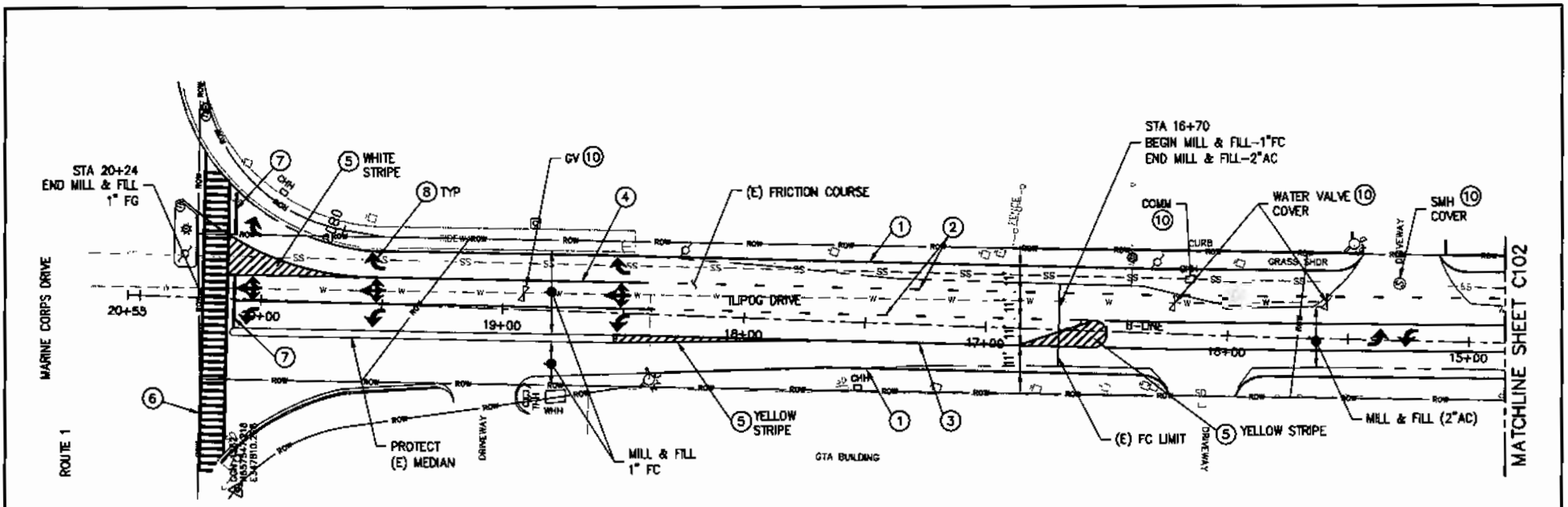

KEYNOTES

- ① 4" WIDE, SOLID WHITE
- ② 4" WIDE, BROKEN WHITE
- ③ 4" WIDE, SOLID YELLOW
- ④ 12" WIDE, SOLID WHITE
- ⑤ DIAGONAL STRIPING WITH RPM
- ⑥ CROSSWALK, DPW STD DWG 634-01
- ⑦ STOP BAR, DPW STD DWG 634-01
- ⑧ DIRECTIONAL ARROW, DPW STD DWG 634-01
- ⑨ 4" WIDE, BROKEN YELLOW
- ⑩ ADJUST UTILITY COVER W/ CONCRETE COLLAR, SEE DPW STD DWG 604-09
- ⑪ SAWCUT LINE
- ⑫ REPLACE STOP SIGN PER DPW STD DWG 633-01

LEGEND

- FULL DEPTH RECONSTRUCTION
- RIGHT OF WAY
- SAWCUT LINE

NOTES:

- 1. STRIPING SHALL BE THERMOPLASTIC MATERIAL (TYPE H) IN ACCORDANCE WITH DPW STANDARDS.
- 2. ILIPOG DRIVE SHALL BE RESTRIPEDED FOLLOWING DPW STANDARDS FOR MULTI-LANE WITH DOUBLE CENTERLINES AND WITH CENTER TURNING LANE AS SHOWN ON DPW STANDARD DRAWING 634-03.

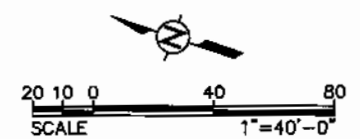

DRAWING REVISIONS				DESIGNER	 CIVIL ENGINEERING, PLANNING, CONSTRUCTION, MANAGEMENT & LAND SURVEYING	HARMON INDUSTRIAL PARK ROADWAY REHABILITATION AND IMPROVEMENT DESIGN PROJECTS		GUAM DEPARTMENT OF PUBLIC WORKS					
REVISION	DATE	BY	DESCRIPTION	DEVELOPER		PHASE 1 - ILIPOG DRIVE IMPROVEMENT		WILAGE	TERRITORY	PROJECT	DRAWING	SHEET NO.	TOTAL NO.
				CHECKER				TIYAN	GUAM	HPA	C101	1	
				DATE									

This work was prepared by me or under my responsible control.

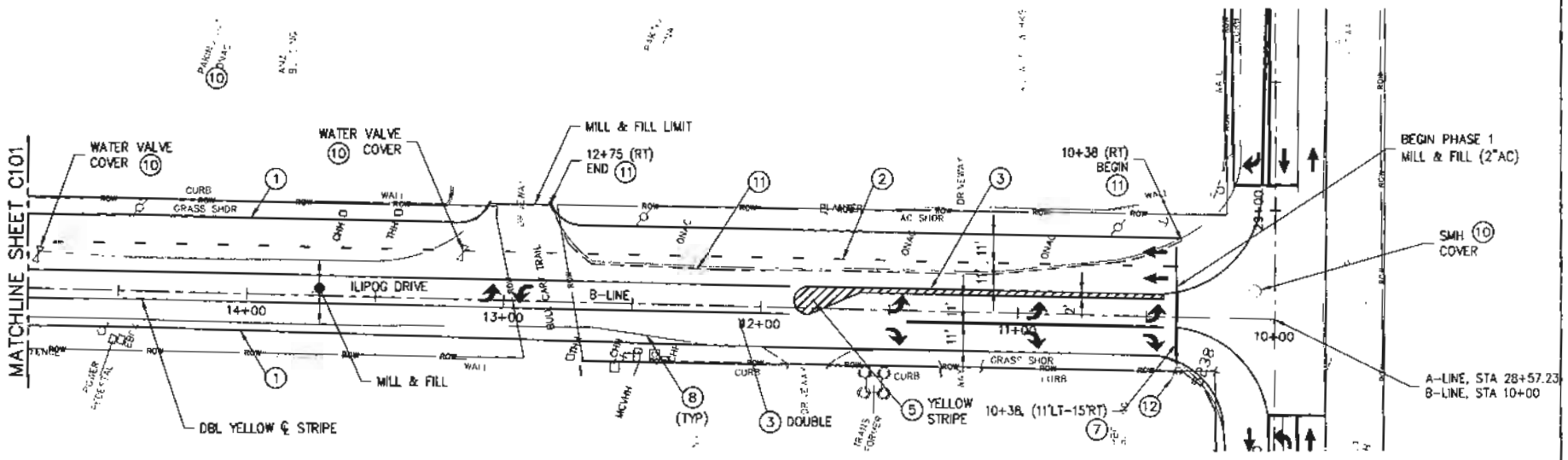

KEYNOTES

- ① 4" WIDE, SOLID WHITE
- ② 4" WIDE, BROKEN WHITE
- ③ 4" WIDE, SOLID YELLOW
- ④ 12" WIDE, SOLID WHITE
- ⑤ DIAGONAL STRIPING WITH RPM
- ⑥ CROSSWALK, DPW STD DWG 634-01
- ⑦ STOP BAR, DPW STD DWG 634-01
- ⑧ DIRECTIONAL ARROW, DPW STD DWG 634-01
- ⑨ 4" WIDE, BROKEN YELLOW
- ⑩ ADJUST UTILITY COVER W/ CONCRETE COLLAR, SEE DPW STD DWG 604-09
- ⑪ SAWCUT LINE
- ⑫ REPLACE STOP SIGN PER DPW STD DWG 633-01

NOTES:

1. STRIPING SHALL BE THERMOPLASTIC MATERIAL (TYPE H) IN ACCORDANCE WITH DPW STANDARDS.
2. ILIPOG DRIVE SHALL BE RESTRIPE FOLLOWING DPW STANDARDS FOR MULTI-LANE WITH DOUBLE CENTERLINES AND WITH CENTER TURNING LANE AS SHOWN ON DPW STANDARD DRAWING 634-03.
3. HARMON INDUSTRIAL PARK ROAD SHALL BE RESTRIPE FOLLOWING DPW STANDARDS FOR 2-LANE WITH CENTER TURNING LANE AS SHOWN ON DPW STANDARD DRAWING 634-02.



This work was prepared by the engineer under the professional control of the registered professional engineer.

DRAWING REVISIONS			
REVISION	DATE	BY	DESCRIPTION

DESIGNER	JE
DEVELOPER	RJ
CHECKER	TG/JE
DATE	MAY 01, 2018

TG ENGINEERS, PC
 CIVIL ENGINEERING, PLANNING, CONSTRUCTION
 MANAGEMENT & LAND SURVEYING

HARMON INDUSTRIAL PARK ROADWAY
 REHABILITATION AND IMPROVEMENT
 DESIGN PROJECTS
 PHASE 1 - ILIPOG DRIVE IMPROVEMENT

GUAM DEPARTMENT OF PUBLIC WORKS					
VILLAGE	REPERYERY	PROJECT	DRAWING NO.	SHEET NO.	TOTAL NO.
TIYAN	GUAM	HIPA	C102	1	

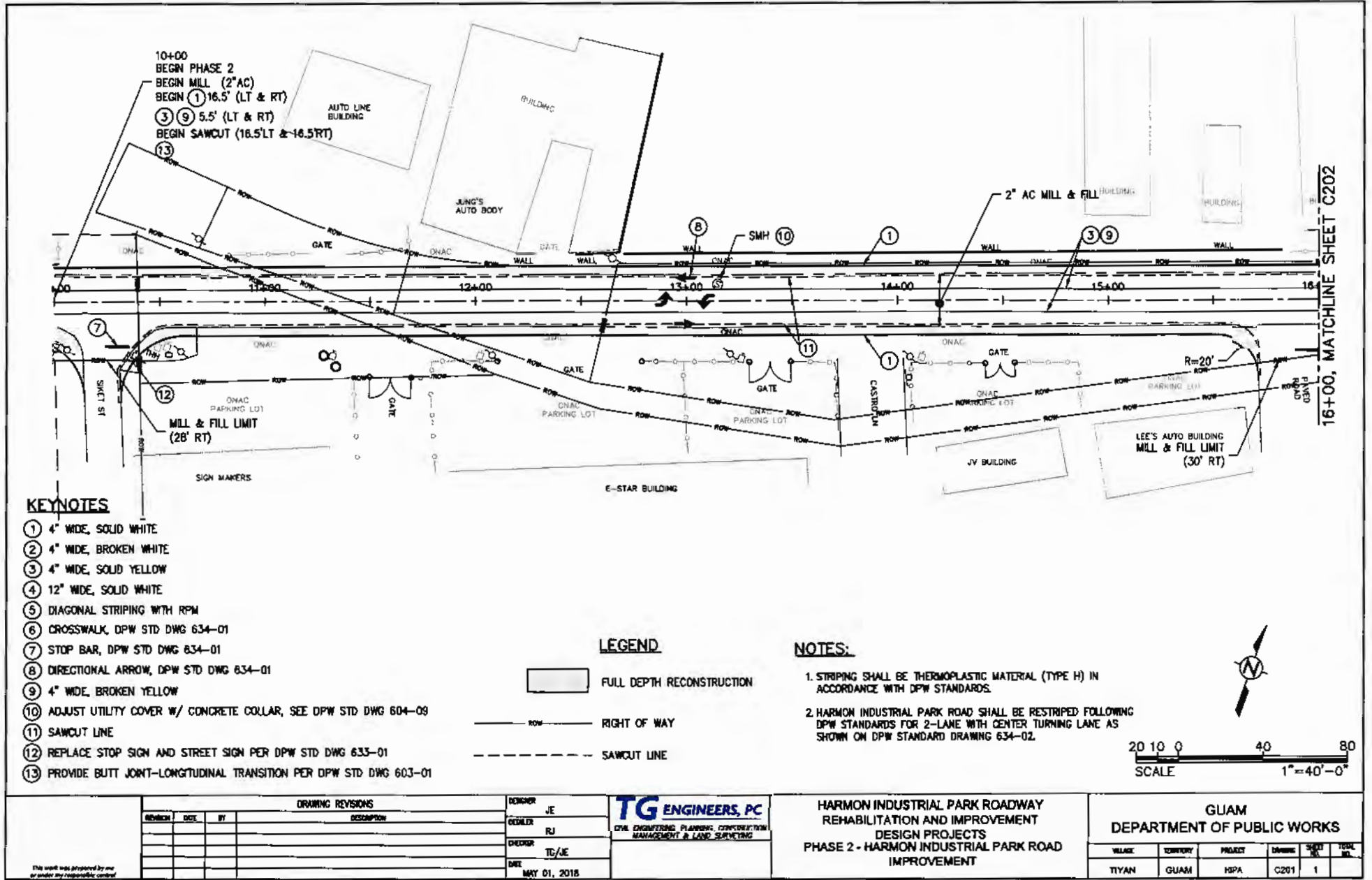

10+00
 BEGIN PHASE 2
 BEGIN MILL (2" AC)
 BEGIN ① 16.5' (LT & RT)
 ③ ⑨ 5.5' (LT & RT)
 BEGIN SAWCUT (18.5' LT & 16.5' RT)

KEYNOTES

- ① 4" WIDE, SOLID WHITE
- ② 4" WIDE, BROKEN WHITE
- ③ 4" WIDE, SOLID YELLOW
- ④ 12" WIDE, SOLID WHITE
- ⑤ DIAGONAL STRIPING WITH RPM
- ⑥ CROSSWALK, DPW STD DWG 634-01
- ⑦ STOP BAR, DPW STD DWG 634-01
- ⑧ DIRECTIONAL ARROW, DPW STD DWG 634-01
- ⑨ 4" WIDE, BROKEN YELLOW
- ⑩ ADJUST UTILITY COVER W/ CONCRETE COLLAR, SEE DPW STD DWG 604-09
- ⑪ SAWCUT LINE
- ⑫ REPLACE STOP SIGN AND STREET SIGN PER DPW STD DWG 633-01
- ⑬ PROVIDE BUTT JOINT-LONGITUDINAL TRANSITION PER DPW STD DWG 603-01

LEGEND

- FULL DEPTH RECONSTRUCTION
- RIGHT OF WAY
- SAWCUT LINE

NOTES:

- 1. STRIPING SHALL BE THERMOPLASTIC MATERIAL (TYPE H) IN ACCORDANCE WITH DPW STANDARDS.
- 2. HARMON INDUSTRIAL PARK ROAD SHALL BE RESTRIPEDED FOLLOWING DPW STANDARDS FOR 2-LANE WITH CENTER TURNING LANE AS SHOWN ON DPW STANDARD DRAWING 634-02.

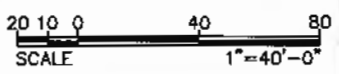

DRAWING REVISIONS			
REVISION	DATE	BY	DESCRIPTION

DESIGNER	JE
CHECKER	RJ
DATE	MAY 01, 2018

TG ENGINEERS, PC
 CIVIL ENGINEERING, PLANNING, CONSTRUCTION
 MANAGEMENT & LAND SURVEYING

HARMON INDUSTRIAL PARK ROADWAY
 REHABILITATION AND IMPROVEMENT
 DESIGN PROJECTS
 PHASE 2 - HARMON INDUSTRIAL PARK ROAD
 IMPROVEMENT

GUAM DEPARTMENT OF PUBLIC WORKS					
WILDCARD	TERRITORY	PROJECT	DRAWING	SHEET NO.	TOTAL SHEETS
	GUAM	HPA	C201	1	

This work was prepared by me or under my responsible control.

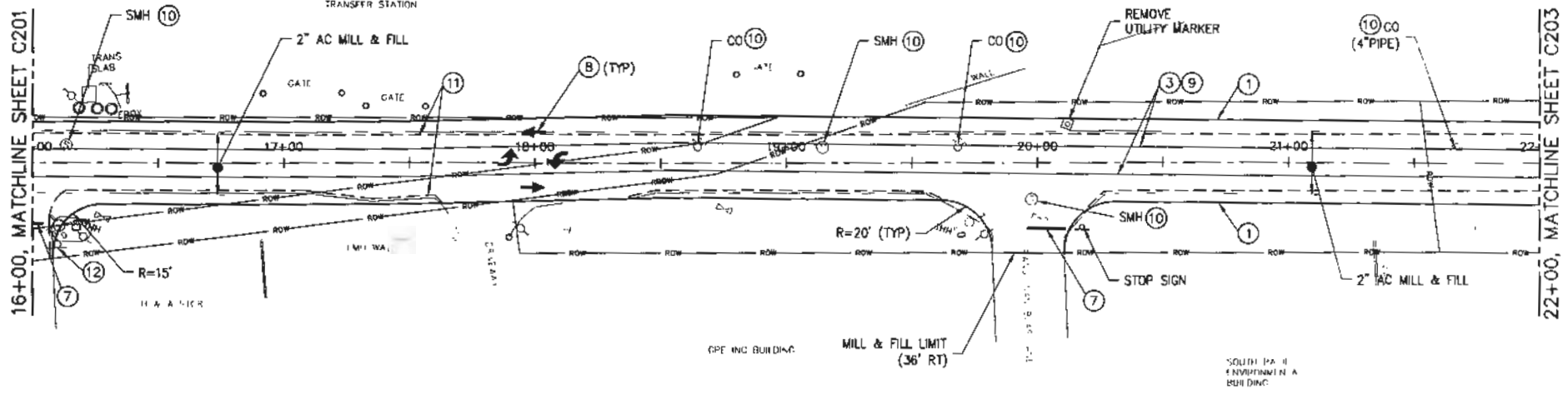

KEYNOTES

- ① 4" WIDE, SOLID WHITE
- ② 4" WIDE, BROKEN WHITE
- ③ 4" WIDE, SOLID YELLOW
- ④ 12" WIDE, SOLID WHITE
- ⑤ DIAGONAL STRIPING WITH RPM
- ⑥ CROSSWALK, DPW STD DWG 634-01
- ⑦ STOP BAR, DPW STD DWG 634-01
- ⑧ DIRECTIONAL ARROW, DPW STD DWG 634-01
- ⑨ 4" WIDE, BROKEN YELLOW
- ⑩ ADJUST UTILITY COVER W/ CONCRETE COLLAR, SEE DPW STD DWG 604-09
- ⑪ SAWCUT LINE
- ⑫ REPLACE STOP SIGN AND STREET SIGN PER DPW STD DWG 633-01
- ⑬ PROVIDE BUTT JOINT-LONGITUDINAL TRANSITION PER DPW STD DWG 603-01

LEGEND

- FULL DEPTH RECONSTRUCTION
- RIGHT OF WAY
- SAWCUT LINE

NOTE:
SEE NOTES ON SHEET C201

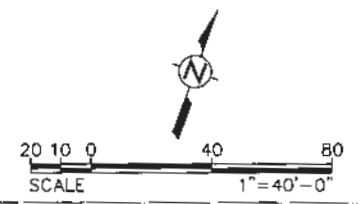

DRAWING REVISIONS			
REVISION	DATE	BY	DESCRIPTION

DESIGNER: JE
 DETAILER: RJ
 CHECKER: YC/JE
 DATE: MAY 01, 2018

TG ENGINEERS, PC
 CIVIL ENGINEERING, PLANNING, CONSTRUCTION
 MANAGEMENT & LAND SURVEYING

HARMON INDUSTRIAL PARK ROADWAY
 REHABILITATION AND IMPROVEMENT
 DESIGN PROJECTS
 PHASE 2 - HARMON INDUSTRIAL PARK ROAD
 IMPROVEMENT

GUAM DEPARTMENT OF PUBLIC WORKS					
VILLAGE	TERRITORY	PROJECT	DRAWING	SHEET NO.	TOTAL NO.
TIYAN	GUAM	HIPA	C201	1	

This work was prepared by me or under my supervision and control.

12+00, MATCHLINE SHEET C202

28+00, MATCHLINE SHEET C204

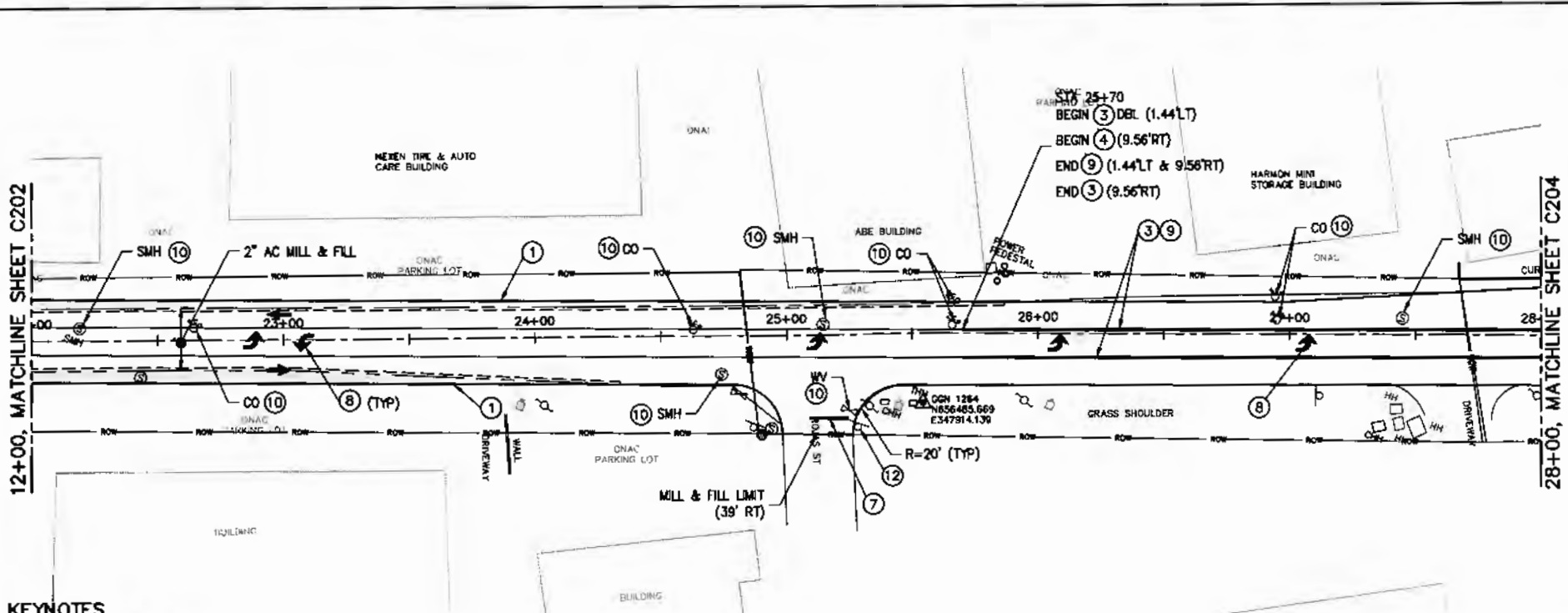

KEYNOTES

- ① 4" WIDE, SOLID WHITE
- ② 4" WIDE, BROKEN WHITE
- ③ 4" WIDE, SOLID YELLOW
- ④ 12" WIDE, SOLID WHITE
- ⑤ DIAGONAL STRIPING WITH RPM
- ⑥ CROSSWALK, DPW STD DWG 634-01
- ⑦ STOP BAR, DPW STD DWG 634-01
- ⑧ DIRECTIONAL ARROW, DPW STD DWG 634-01
- ⑨ 4" WIDE, BROKEN YELLOW
- ⑩ ADJUST UTILITY COVER W/ CONCRETE COLLAR, SEE DPW STD DWG 604-09
- ⑪ SAWCUT LINE
- ⑫ REPLACE STOP SIGN AND STREET SIGN PER DPW STD DWG 633-01
- ⑬ PROMDE BUTT JOINT-LONGITUDINAL TRANSITION PER DPW STD DWG 603-01

LEGEND

- FULL DEPTH RECONSTRUCTION
- ROW — RIGHT OF WAY
- - - SAWCUT LINE

NOTE:
SEE NOTES ON SHEET C201

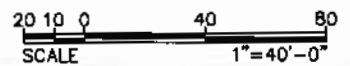

DRAWING REVISIONS			
REVISION	DATE	BY	DESCRIPTION

DESIGNER: JE
 DRAWER: RJ
 CHECKER: TB/JE
 DATE: MAY 01, 2018

TG ENGINEERS, PC
 CIVIL ENGINEERING, PLANNING, CONSTRUCTION MANAGEMENT & LAND SURVEYING

HARMON INDUSTRIAL PARK ROADWAY REHABILITATION AND IMPROVEMENT DESIGN PROJECTS
 PHASE 2 - HARMON INDUSTRIAL PARK ROAD IMPROVEMENT

GUAM DEPARTMENT OF PUBLIC WORKS					
VILLAGE	TERRITORY	PROJECT	DRAWING NO.	SHEET NO.	TOTAL SHEETS
TIYAN	GUAM	HPA	C203	1	

This work was prepared by the engineer under my responsible control.

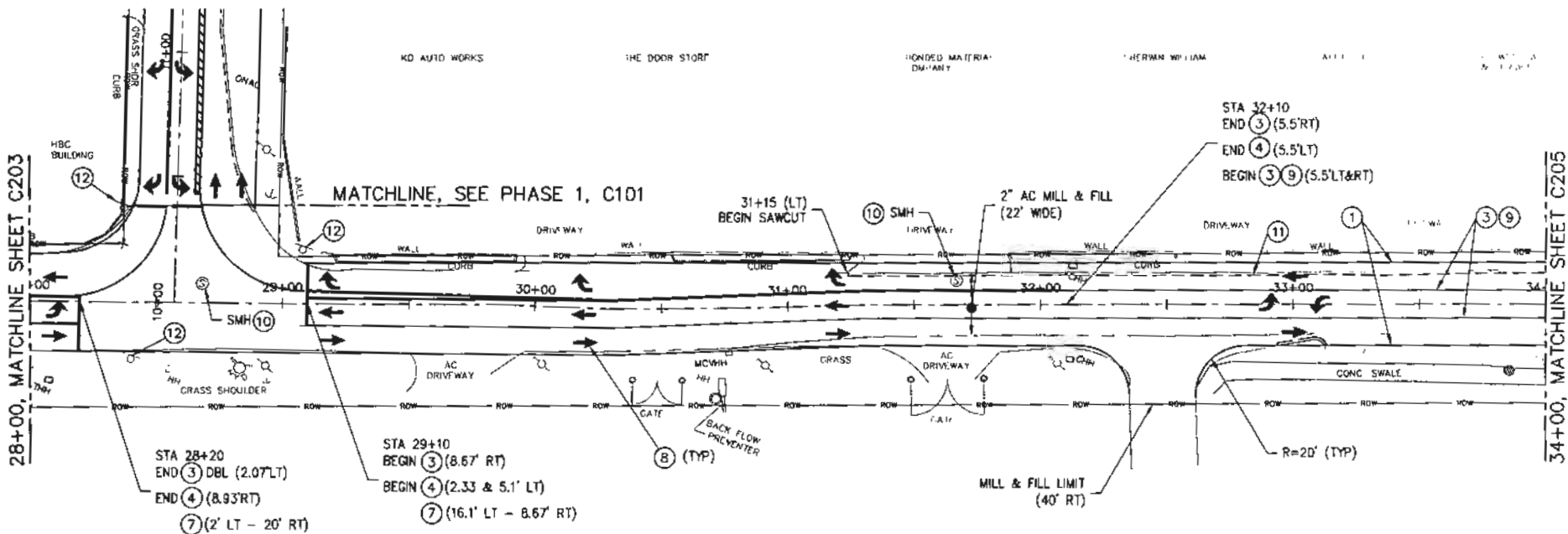

KEYNOTES

- ① 4" WIDE, SOLID WHITE
- ② 4" WIDE, BROKEN WHITE
- ③ 4" WIDE, SOLID YELLOW
- ④ 12" WIDE, SOLID WHITE
- ⑤ DIAGONAL STRIPING WITH RPM
- ⑥ CROSSWALK, DPW STD DWG 634-01
- ⑦ STOP BAR, DPW STD DWG 634-01
- ⑧ DIRECTIONAL ARROW, DPW STD DWG 634-01
- ⑨ 4" WIDE, BROKEN YELLOW
- ⑩ ADJUST UTILITY COVER W/ CONCRETE COLLAR, SEE DPW STD DWG 604-09
- ⑪ SAWCUT LINE
- ⑫ REPLACE STOP SIGN AND STREET SIGN PER DPW STD DWG 633-01
- ⑬ PROVIDE BUTT JOINT-LONGITUDINAL TRANSITION PER DPW STD DWG 603-01

LEGEND

- FULL DEPTH RECONSTRUCTION
- RIGHT OF WAY
- SAWCUT LINE

NOTE:
SEE NOTES ON SHEET C201



DRAWING REVISIONS			
REVISION	DATE	BY	DESCRIPTION

DESIGNER	JE
DETAILER	RJ
CHECKER	TG/JE
DATE	MAY 01, 2018

TG ENGINEERS, PC
CIVIL ENGINEERING, PLANNING, CONSTRUCTION
MANAGEMENT & LAND SURVEYING

HARMON INDUSTRIAL PARK ROADWAY
REHABILITATION AND IMPROVEMENT
DESIGN PROJECTS
PHASE 2 - HARMON INDUSTRIAL PARK ROAD
IMPROVEMENT

GUAM DEPARTMENT OF PUBLIC WORKS					
VILLAGE	TERRITORY	PROJECT	DRAWING NO.	SHEET NO.	TOTAL NO.
TIYAN	GUAM	HPA	C204	1	

This work was prepared by me or under my responsible control.

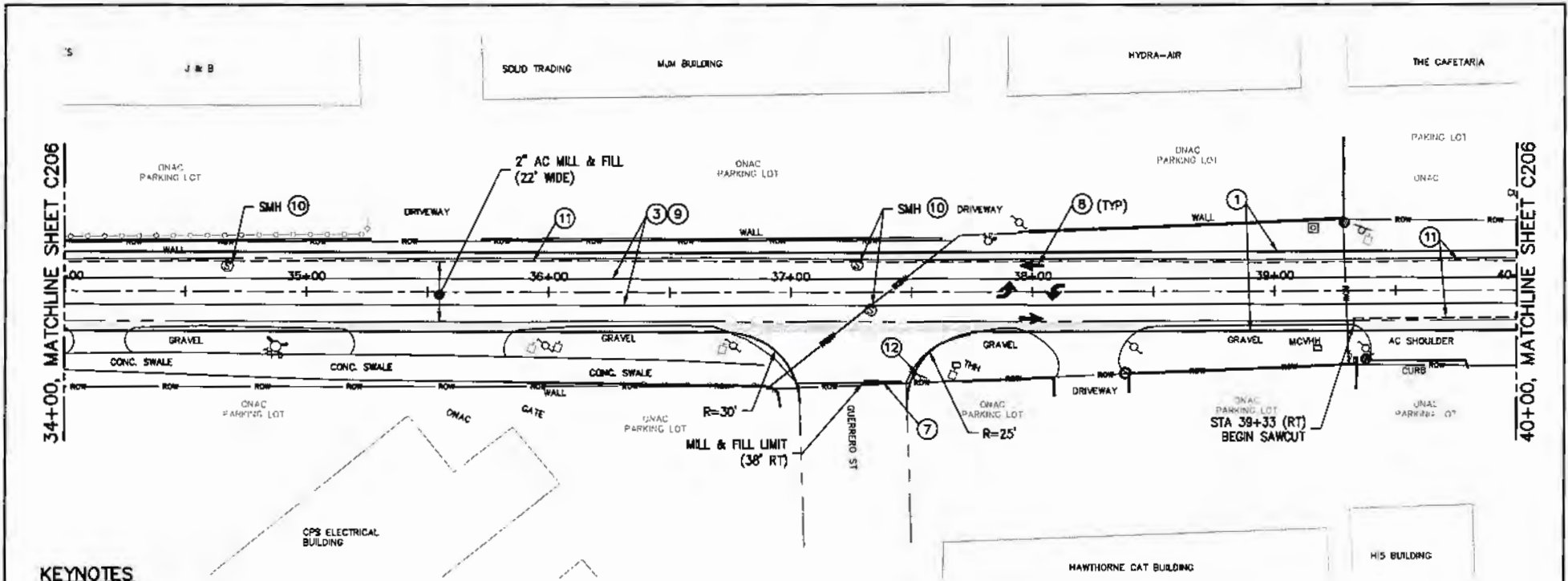

KEYNOTES

- ① 4" WIDE, SOLID WHITE
- ② 4" WIDE, BROKEN WHITE
- ③ 4" WIDE, SOLID YELLOW
- ④ 12" WIDE, SOLID WHITE
- ⑤ DIAGONAL STRIPING WITH RPM
- ⑥ CROSSWALK, DPW STD DWG 634-01
- ⑦ STOP BAR, DPW STD DWG 634-01
- ⑧ DIRECTIONAL ARROW, DPW STD DWG 634-01
- ⑨ 4" WIDE, BROKEN YELLOW
- ⑩ ADJUST UTILITY COVER W/ CONCRETE COLLAR, SEE DPW STD DWG 604-08
- ⑪ SAWCUT LINE
- ⑫ REPLACE STOP SIGN AND STREET SIGN PER DPW STD DWG 633-01
- ⑬ PROVIDE BUTT JOINT-LONGITUDINAL TRANSITION PER DPW STD DWG 603-01

LEGEND

- FULL DEPTH RECONSTRUCTION
- RIGHT OF WAY
- SAWCUT LINE

NOTE:
SEE NOTES ON SHEET C201

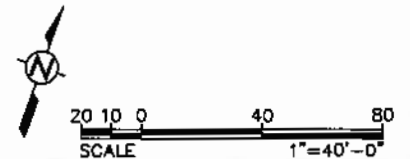

<p style="font-size: 8px;">This sheet was prepared by the or under my responsible control</p>	<p style="text-align: center;">DRAWING REVISIONS</p> <table border="1" style="width: 100%; border-collapse: collapse;"> <thead> <tr> <th style="width: 10%;">REVISION</th> <th style="width: 10%;">DATE</th> <th style="width: 10%;">BY</th> <th style="width: 70%;">DESCRIPTION</th> </tr> </thead> <tbody> <tr><td> </td><td> </td><td> </td><td> </td></tr> <tr><td> </td><td> </td><td> </td><td> </td></tr> <tr><td> </td><td> </td><td> </td><td> </td></tr> <tr><td> </td><td> </td><td> </td><td> </td></tr> </tbody> </table>	REVISION	DATE	BY	DESCRIPTION																	<p>DESIGNER: JE</p> <p>DRAWER: RJ</p> <p>CHECKER: TG/AE</p> <p>DATE: MAY 01, 2018</p>	<p>TG ENGINEERS, PC</p> <p style="font-size: 8px;">CIVIL ENGINEERING, PLANNING, CONSTRUCTION MANAGEMENT & LAND SURVEYING</p>	<p>HARMON INDUSTRIAL PARK ROADWAY REHABILITATION AND IMPROVEMENT DESIGN PROJECTS PHASE 2 - HARMON INDUSTRIAL PARK ROAD IMPROVEMENT</p>	<p>GUAM DEPARTMENT OF PUBLIC WORKS</p> <table border="1" style="width: 100%; border-collapse: collapse;"> <thead> <tr> <th style="width: 10%;">VILLAGE</th> <th style="width: 10%;">TERRITORY</th> <th style="width: 10%;">PROJECT</th> <th style="width: 10%;">DRAWING NO.</th> <th style="width: 10%;">SHEET NO.</th> <th style="width: 10%;">TOTAL SHEETS</th> </tr> </thead> <tbody> <tr> <td>TTYAN</td> <td>GUAM</td> <td>HPA</td> <td>C205</td> <td>1</td> <td> </td> </tr> </tbody> </table>	VILLAGE	TERRITORY	PROJECT	DRAWING NO.	SHEET NO.	TOTAL SHEETS	TTYAN	GUAM	HPA	C205	1	
REVISION	DATE	BY	DESCRIPTION																																		
VILLAGE	TERRITORY	PROJECT	DRAWING NO.	SHEET NO.	TOTAL SHEETS																																
TTYAN	GUAM	HPA	C205	1																																	

40+00, MATCHLINE SHEET C205

46+00, MATCHLINE SHEET C207

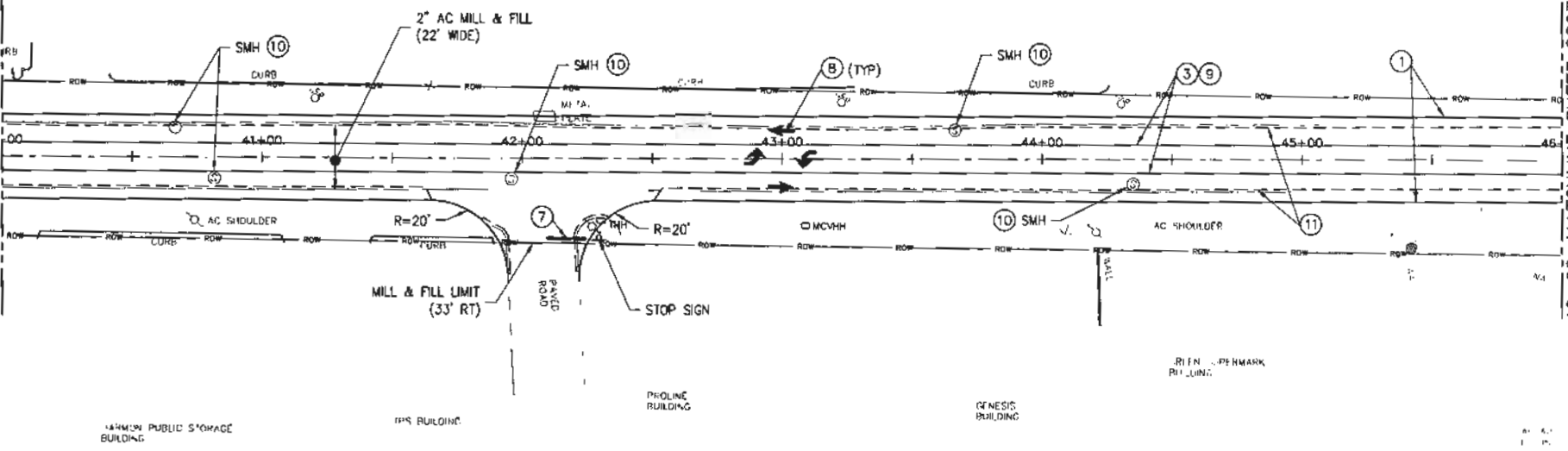

KEYNOTES

- ① 4" WIDE, SOLID WHITE
- ② 4" WIDE, BROKEN WHITE
- ③ 4" WIDE, SOLID YELLOW
- ④ 12" WIDE, SOLID WHITE
- ⑤ DIAGONAL STRIPING WITH RPM
- ⑥ CROSSWALK, DPW STD DWG 634-01
- ⑦ STOP BAR, DPW STD DWG 634-01
- ⑧ DIRECTIONAL ARROW, DPW STD DWG 634-01
- ⑨ 4" WIDE, BROKEN YELLOW
- ⑩ ADJUST UTILITY COVER W/ CONCRETE COLLAR, SEE DPW STD DWG 604-09
- ⑪ SAWCUT LINE
- ⑫ REPLACE STOP SIGN AND STREET SIGN PER DPW STD DWG 633-01
- ⑬ PROVIDE BUTT JOINT-LONGITUDINAL TRANSITION PER DPW STD DWG 603-01

LEGEND

- FULL DEPTH RECONSTRUCTION
- RIGHT OF WAY
- SAWCUT LINE

NOTE:
SEE NOTES ON SHEET C201

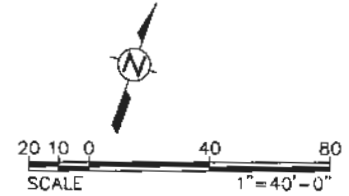

This work was prepared by me or under my responsible control.	DRAWING REVISIONS				DESIGNER JE	TG ENGINEERS, PC CIVIL ENGINEERING, PLANNING, CONSTRUCTION MANAGEMENT & LAND SURVEYING	HARMON INDUSTRIAL PARK ROADWAY REHABILITATION AND IMPROVEMENT DESIGN PROJECTS PHASE 2 - HARMON INDUSTRIAL PARK ROAD IMPROVEMENT	GUAM DEPARTMENT OF PUBLIC WORKS				
	REVISION	DATE	BY	DESCRIPTION	DETAILER RJ			CHECKER TG/JE	DATE MAY 01, 2018	VILLAGE TITIAN	TERRITORY GUAM	PROJECT HIPA

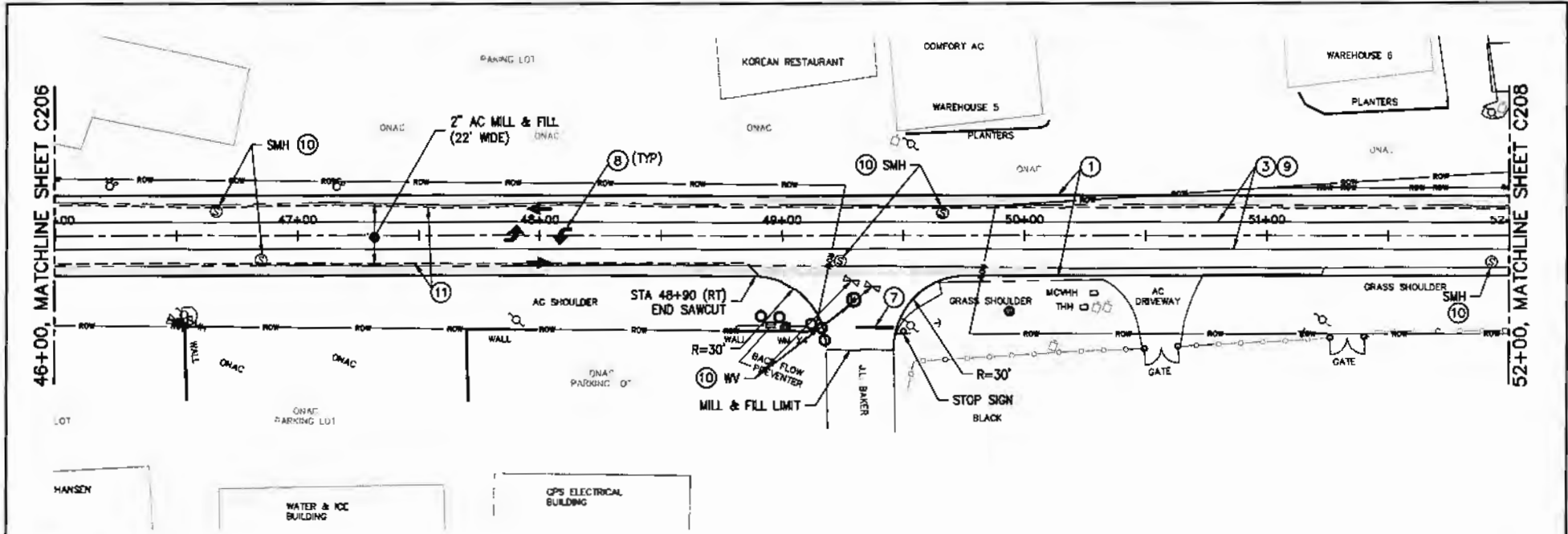

KEYNOTES

- ① 4" WIDE, SOLID WHITE
- ② 4" WIDE, BROKEN WHITE
- ③ 4" WIDE, SOLID YELLOW
- ④ 12" WIDE, SOLID WHITE
- ⑤ DIAGONAL STRIPING WITH RPM
- ⑥ CROSSWALK, DPW STD DWG 634-01
- ⑦ STOP BAR, DPW STD DWG 634-01
- ⑧ DIRECTIONAL ARROW, DPW STD DWG 634-01
- ⑨ 4" WIDE, BROKEN YELLOW
- ⑩ ADJUST UTILITY COVER W/ CONCRETE COLLAR, SEE DPW STD DWG 604-09
- ⑪ SAWCUT LINE
- ⑫ REPLACE STOP SIGN AND STREET SIGN PER DPW STD DWG 633-01
- ⑬ PROVIDE BUTT JOINT-LONGITUDINAL TRANSITION PER DPW STD DWG 603-01

LEGEND

- FULL DEPTH RECONSTRUCTION
- RIGHT OF WAY
- SAWCUT LINE

NOTE:
SEE NOTES ON SHEET C201

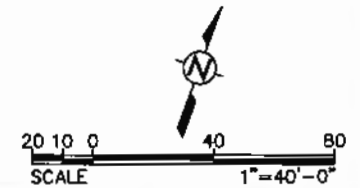

This work was prepared by me or under my responsible control

DRAWING REVISIONS			
REVISION	DATE	BY	DESCRIPTION

DESIGNER	JE
DRAWN	RJ
CHECKED	TB/JE
DATE	MAY 01, 2018

TG ENGINEERS, PC
CIVIL ENGINEERING, PLANNING, CONSTRUCTION
MANAGEMENT & LAND SURVEYING

HARMON INDUSTRIAL PARK ROADWAY
REHABILITATION AND IMPROVEMENT
DESIGN PROJECTS
PHASE 2 - HARMON INDUSTRIAL PARK ROAD
IMPROVEMENT

GUAM DEPARTMENT OF PUBLIC WORKS					
WALINE	TERRITORY	PROJECT	DRAWING	SHEET NO.	TOTAL NO.
TITIAN	GUAM	HPA	C207	1	

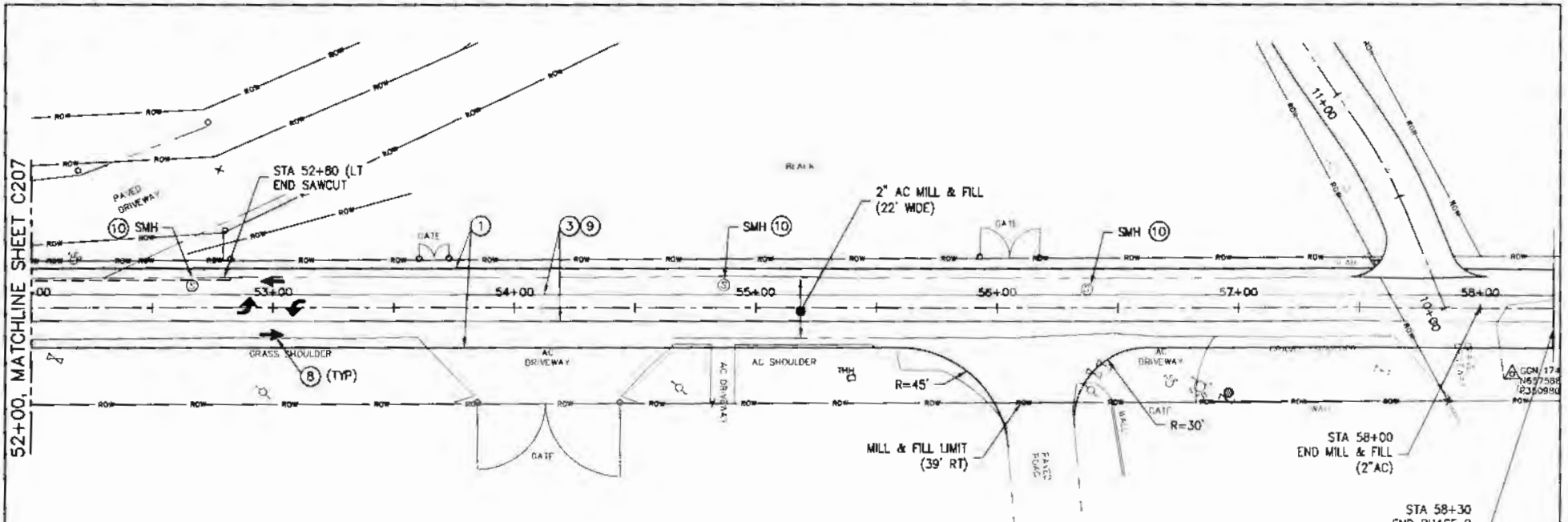

52+00, MATCHLINE SHEET C207

KEYNOTES

- ① 4" WIDE, SOLID WHITE
- ② 4" WIDE, BROKEN WHITE
- ③ 4" WIDE, SOLID YELLOW
- ④ 12" WIDE, SOLID WHITE
- ⑤ DIAGONAL STRIPING WITH RPM
- ⑥ CROSSWALK, DPW STD DWG 634-01
- ⑦ STOP BAR, DPW STD DWG 634-01
- ⑧ DIRECTIONAL ARROW, DPW STD DWG 634-01
- ⑨ 4" WIDE, BROKEN YELLOW
- ⑩ ADJUST UTILITY COVER W/ CONCRETE COLLAR, SEE DPW STD DWG 604-09
- ⑪ SAWCUT LINE
- ⑫ REPLACE STOP SIGN AND STREET SIGN PER DPW STD DWG 633-01
- ⑬ PROVIDE BUTT JOINT-LONGITUDINAL TRANSITION PER DPW STD DWG 603-01

LEGEND

- FULL DEPTH RECONSTRUCTION
- RIGHT OF WAY
- SAWCUT LINE

NOTE:
SEE NOTES ON SHEET C201

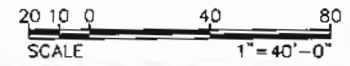

DRAWING REVISIONS				DESIGNED	 CIVIL ENGINEERING, PLANNING, CONSTRUCTION MANAGEMENT & LAND SURVEYING	HARMON INDUSTRIAL PARK ROADWAY REHABILITATION AND IMPROVEMENT DESIGN PROJECTS PHASE 2 - HARMON INDUSTRIAL PARK ROAD IMPROVEMENT					GUAM DEPARTMENT OF PUBLIC WORKS				
REVISION	DATE	BY	DESCRIPTION	DATE		VILLAGE	TERRITORY	PROJECT	DRAWING NO.	SHEET NO.	TOTAL NO.				

This work was prepared by the firm and its employees and is the property of the firm.

DESIGNED: JE
 CHECKED: RJ
 DATE: MAY 01, 2018

VILLAGE	TERRITORY	PROJECT	DRAWING NO.	SHEET NO.	TOTAL NO.
TIYAN	GUAM	HIPA	C208	1	

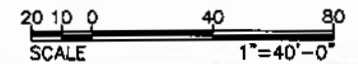
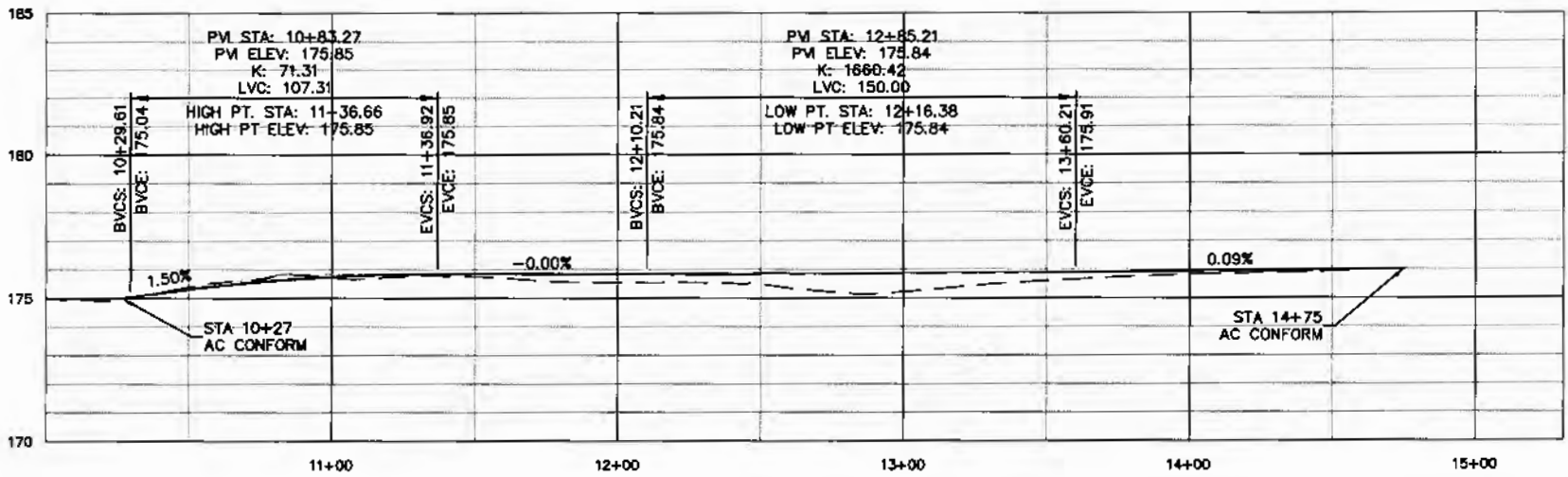
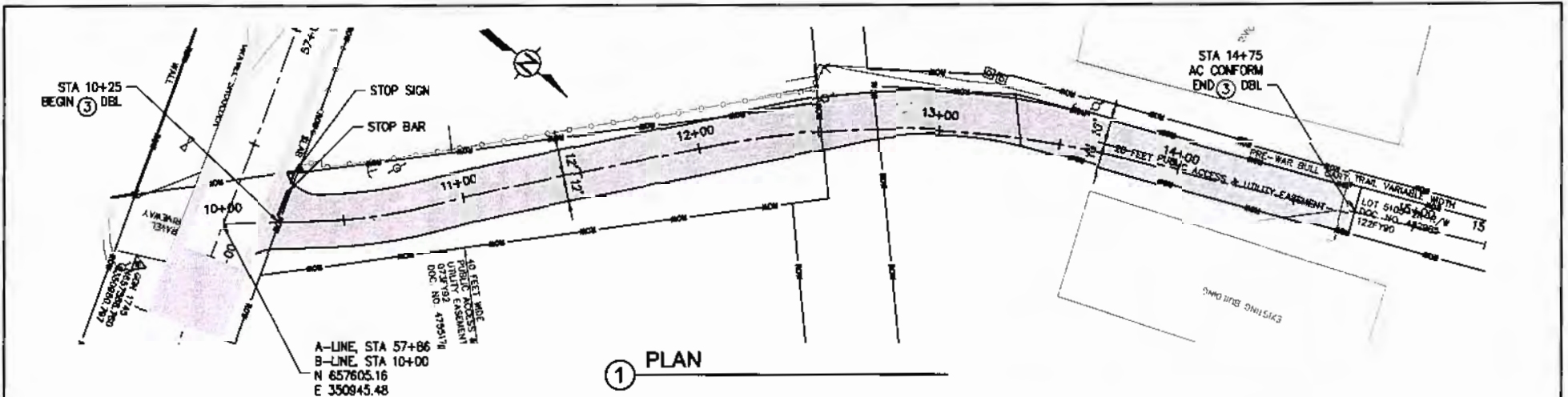

DRAWING REVISIONS				DESIGNER	 <small>ONE ENGINEERING, PLANNING, CONSTRUCTION MANAGEMENT & LAND SURVEYING</small>	HARMON INDUSTRIAL PARK ROADWAY REHABILITATION AND IMPROVEMENT DESIGN PROJECTS		GUAM DEPARTMENT OF PUBLIC WORKS			
REVISION	DATE	BY	DESCRIPTION	DATE		PHASE	OWNER	PROJECT	CONTRACT	SHEET NO.	TOTAL SHEETS
				JE	PHASE 2A - HARMON INDUSTRIAL ROAD TO HAMBURGER HIGHWAY	TIYAN	GUAM	HFA	C301	1	1
				RJ							
				TG/JE							
				DATE	MAY 01, 2018						

This work was prepared by me or under my responsible control

GENERAL NOTES:

1. PLACE CURB INLET PROTECTION AT A LOW POINT IN THE CURB PROFILE TO ALLOW SEDIMENT TO SEPARATE FROM RUNOFF
2. SANDBAGS, OF EITHER BURLAP OR WOVEN GEOTEXTILE FABRIC, SHALL BE FILLED WITH GRAVEL, AND STACKED TIGHTLY
3. LEAVE ONE SANDBAG GAP IN THE TOP ROW TO PROVIDE A SPILLWAY FOR OVERFLOW. TOP OF THE SPILLWAY SHALL BE BELOW THE TOP OF CURB ELEVATION
4. INSPECT BARRIERS AND REMOVE SEDIMENT AFTER EACH STORM EVENT

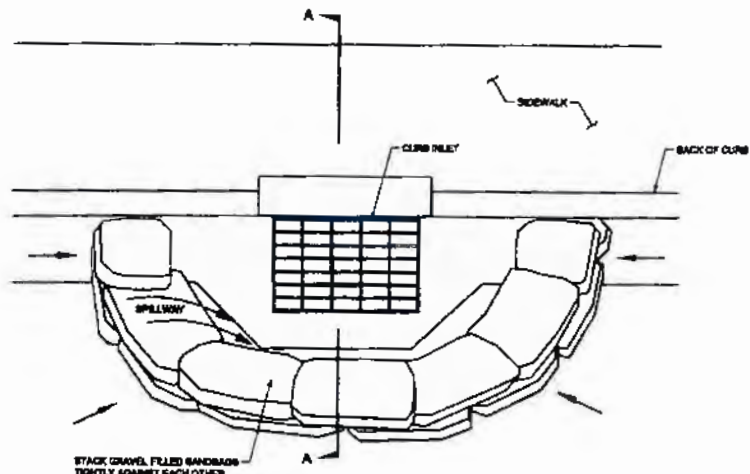

PLAN VIEW

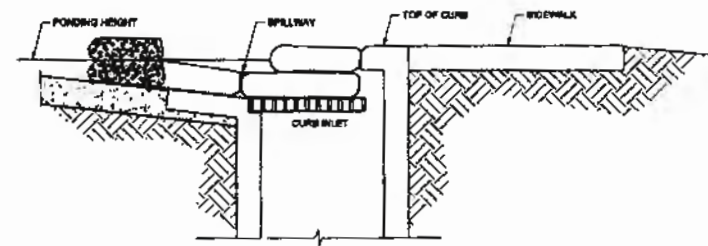

SECTION A - A

SIGNED ORIGINAL ON FILE

DRAWING REVISIONS				
NO.	DATE	BY	REVISION	REVISION



Guam Department of Public Works
 542 North Marine Corps Drive
 Tamuning, Guam 96913
 Tel: (671) 646-3133
 Fax: (671) 649-6178

TEMPORARY CURB INLET PROTECTION

APPROVED FOR USE ON OPW PROJECTS		DATE: 10/14/12
CHIEF ENGINEER, HIGHWAYS DEPARTMENT OF PUBLIC WORKS		[Signature] [Signature]
STANDARD NO.	157-02	

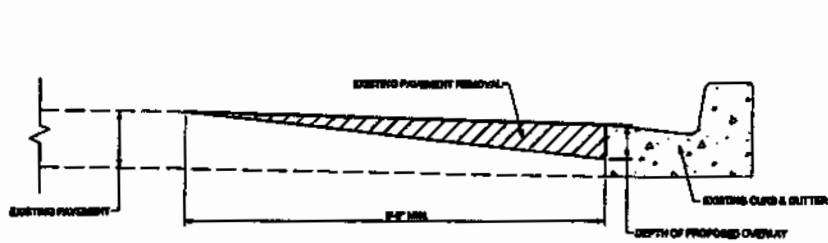

PAVEMENT REMOVAL

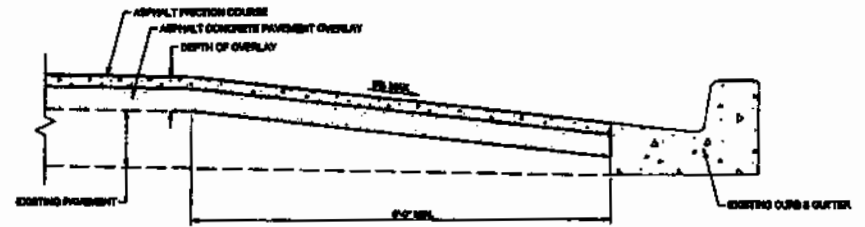

PAVEMENT OVERLAY

TAPER DETAIL FOR EXISTING CURB & GUTTER



PAVEMENT REMOVAL

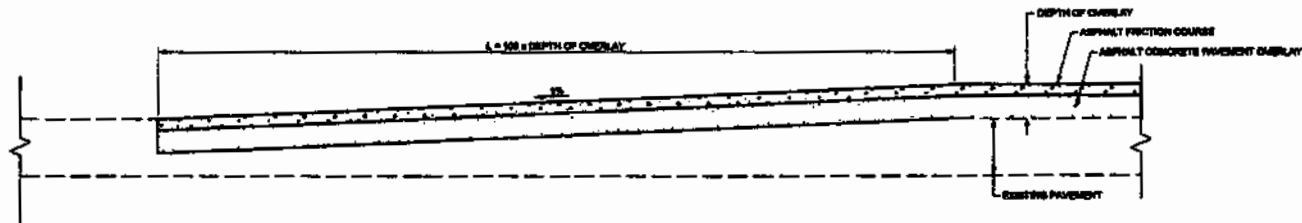

PAVEMENT OVERLAY

BUTT JOINT- LONGITUDINAL SECTION

SEE
ORIGINAL
ON FILE

DRAWING REVISIONS				
NO.	DATE	BY	DESCRIPTION	REVISION



Queens Department of Public Works
 842 North Marine Parade Drive
 Townsville, Queensland 4801
 Tel: (077) 648-3133
 Fax: (077) 648-6378

ASPHALT PAVEMENT OVERLAY TRANSITIONS

APPROVED FOR USE ON DPW PROJECTS

[Signature]
 DATE: 10/16/12

STANDARD NO.

403-01

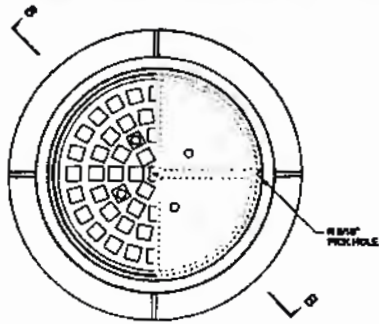

PLAN

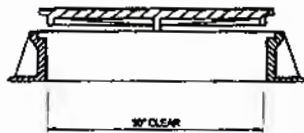

SECTION B-B

TRAFFIC-STRENGTH
MANHOLE FRAME & COVER

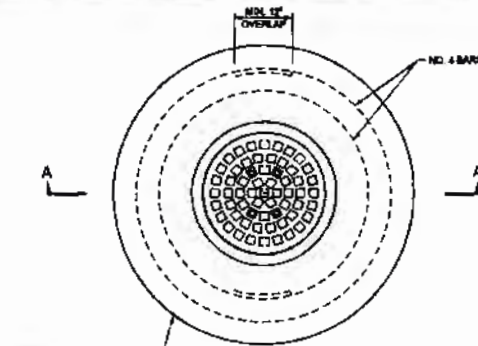

EDGE OF CONCRETE COLLAR
1/4\"/>

CONCRETE COLLAR PLAN

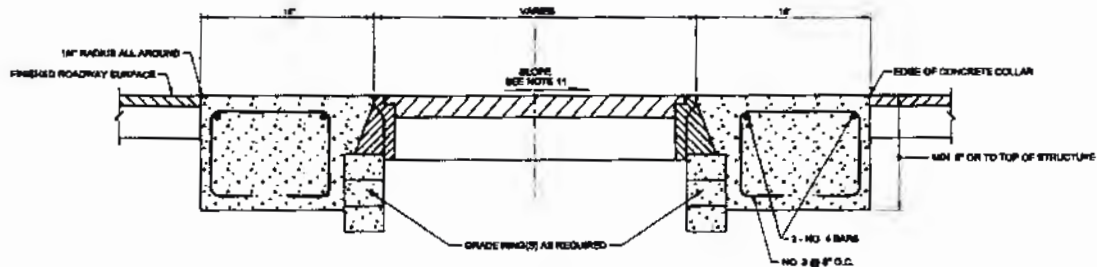

GENERAL NOTES:

1. TRAFFIC-STRENGTH MANHOLE FRAME & COVER SHALL COMPLY WITH AASHTO M19 WHEEL LOADS EQUIVALENT MANHOLE FRAMES & COVERS OTHER THAN SHOWN MAY BE USED UPON APPROVAL BY THE ENGINEER.
2. THE FRAME BEAT AND COVER BEAT SHALL BE MACHINED TO A TRUE BEARING SURFACE ALL AROUND.
3. THE SURFACE SHOWN IS FOR ILLUSTRATION ONLY. ANY SURFACE DESIGN OTHER THAN SMOOTH MAY BE USED UPON APPROVAL.
4. FRAMES & COVERS SHALL CONFORM TO ASTM A48, CLASS 48 FOR GRAY IRON CASTINGS.
5. A CAST-IN-PLACE CONCRETE COLLAR SHALL BE PLACED AROUND A MANHOLE FRAME (UNLESS OTHERWISE DIRECTED).
6. MANHOLE COVER SHALL BEAR NAME OF OWNER & SYSTEM FUNCTION (IF APPLICABLE).
7. CONCRETE SHALL CONFORM TO THE REQUIREMENTS OF F1-03 SECTION 901 MINOR CONCRETE STRUCTURE.
8. CONCRETE COLLARS MAY BE POLISHED ROUND OR ANY OTHER APPROPRIATE SHAPE WHEN APPROVED BY THE ENGINEER.
9. COMMERCIAL PREFABRICATED GRADE RINGS FOR MANHOLES SHALL CONFORM TO AASHTO M 198 (ASTM C-478).
10. MANHOLE COVER & FRAME SHOWN. OTHER SHAPES MAY APPLY TO UTILITY AND VALVE COVERS AND FRAMES.
11. THE SLOPE OF THE MANHOLE COVER AND COLLAR SHALL MATCH THE ROADWAY PROFILE AND CROSS-SLOPE.

SIGNED
ORIGINAL
ON FILE

DRAWING REVISIONS			
REVISION	DATE	BY	DESCRIPTION



Guam Department of Public Works
542 North Marine Corps Drive
Tamuning, Guam 96913
Tel: (671) 646-3131
Fax: (671) 646-6178

MANHOLE COVER, FRAME,
& CONCRETE COLLAR

APPROVED FOR USE ON DPW PROJECTS

CHIEF ENGINEER OF HIGHWAYS
DEPARTMENT OF PUBLIC WORKS

DATE 10-14-12

STANDARD NO.

604-09

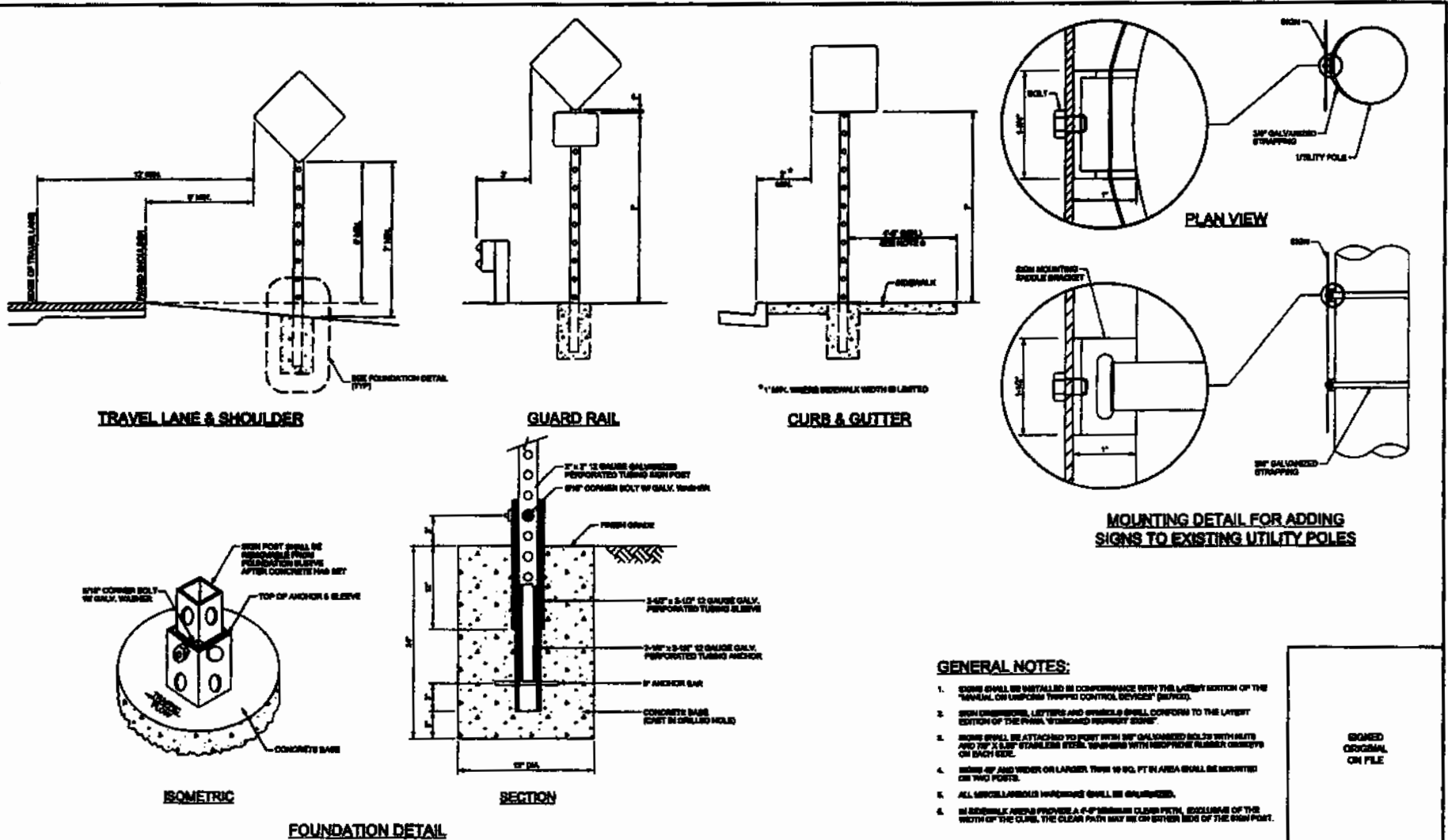

DRAWING REVISIONS			
NO.	DATE	BY	REVISION



Grand Department of Public Works
 542 North Interstate Corridor Drive
 Tallahassee, Georgia 32310
 Tel: (907) 646-5162
 Fax: (907) 643-6178

ROADSIDE SIGN INSTALLATION

APPROVED FOR USE ON DPW PROJECTS	DATE: 10/14/12
 <small>Robert A. Kelly COUNTY ENGINEER DEPARTMENT OF PUBLIC WORKS</small>	 <small>DATE: 10/14/12</small>
STANDARD NO.	833-01

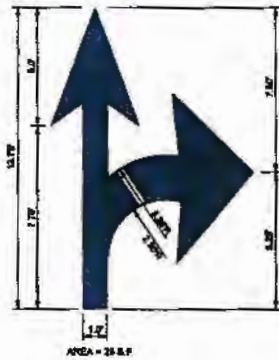
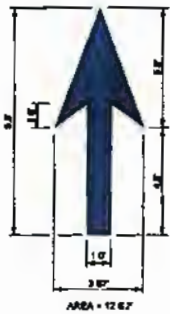

DIRECTIONAL ARROWS

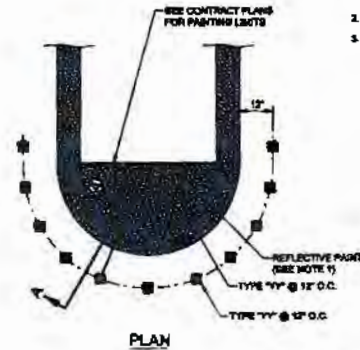

NOTES

1. ENTIRE MEDIAN NOSE AND ALL MEDIAN CURBS SHALL BE PAINTED WITH YELLOW REFLECTIVE PAINT
2. SEE RAISED PAVEMENT MARKERS DETAIL.
3. RAISED PAVEMENT MARKERS SHALL BE ALIGNED TO FACE ONCOMING TRAFFIC.

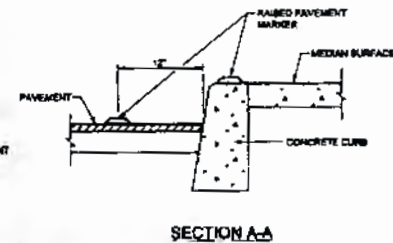

MEDIAN NOSE MARKINGS

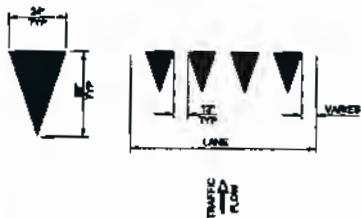

YIELD BAR
PLACED PERPENDICULAR TO TRAVEL LINES

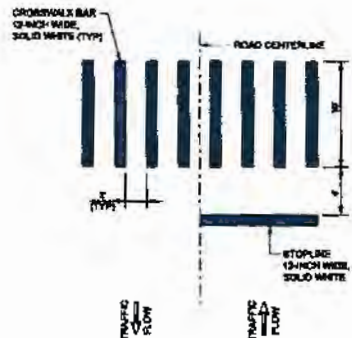

CROSSWALK PAVEMENT MARKINGS

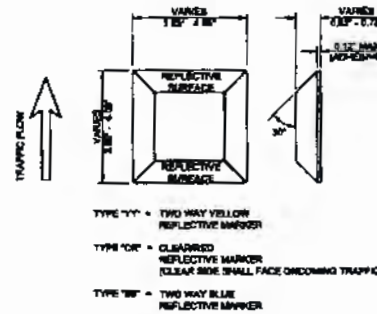

RAISED PAVEMENT MARKERS
(REFLECTORIZE MARKS)

- TYPE 'YY' - TWO WAY YELLOW REFLECTIVE MARKER
- TYPE 'OR' - CLEARPAINT REFLECTIVE MARKER (CLEAR SIDE SHALL FACE ONCOMING TRAFFIC)
- TYPE 'BB' - TWO WAY BLUE REFLECTIVE MARKER

GENERAL NOTE:

1. ALL PERMANENT PAVEMENT MARKERS SHALL BE THERMOPLASTIC MATERIAL (TYPE K)

SKIPPED ORIGINAL ON FILE

DRAWING REVISIONS			
REVISION	DATE	BY	DESCRIPTION



Guam Department of Public Works
542 North Marine Corps Drive
Terranova, Guam 96913
Tel: (671) 646-3131
Fax: (671) 649-6176

PAVEMENT MARKERS, MARKINGS AND DIRECTIONAL ARROWS

APPROVED FOR USE ON DPW PROJECTS	DATE 10.14.12
 CHIEF ENGINEER, HIGHWAYS DEPARTMENT OF PUBLIC WORKS	
STANDARD NO.	634-01

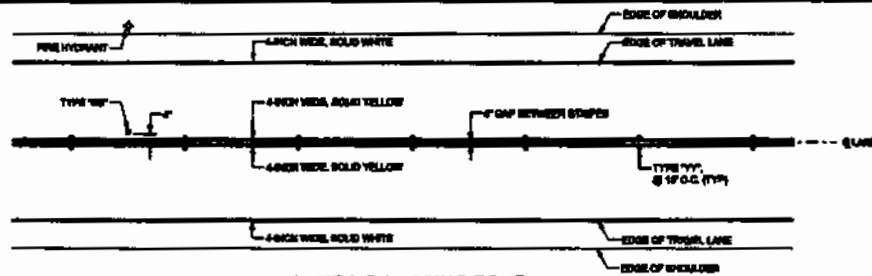

2-LANE NO PASSING ZONE
NOT TO SCALE

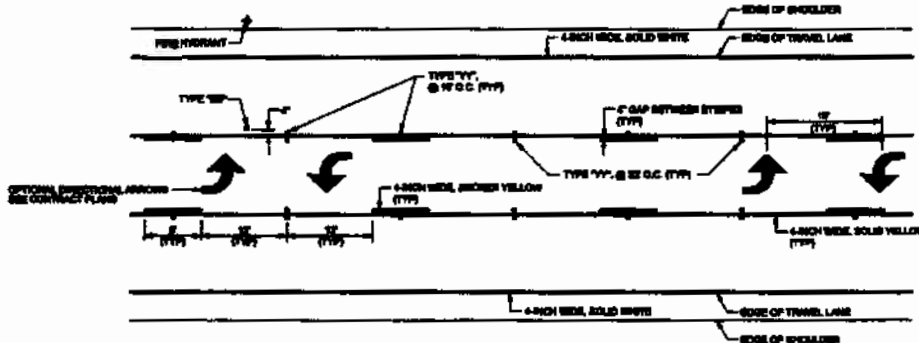

2-LANE WITH CENTER TURNING LANE
NOT TO SCALE

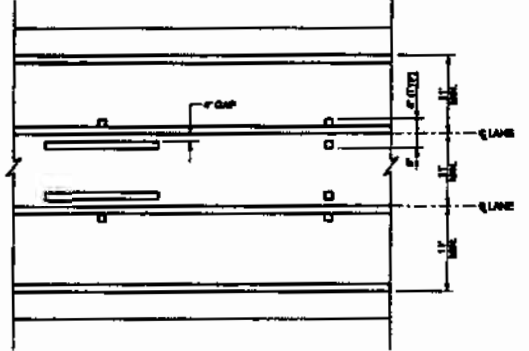

DETAIL

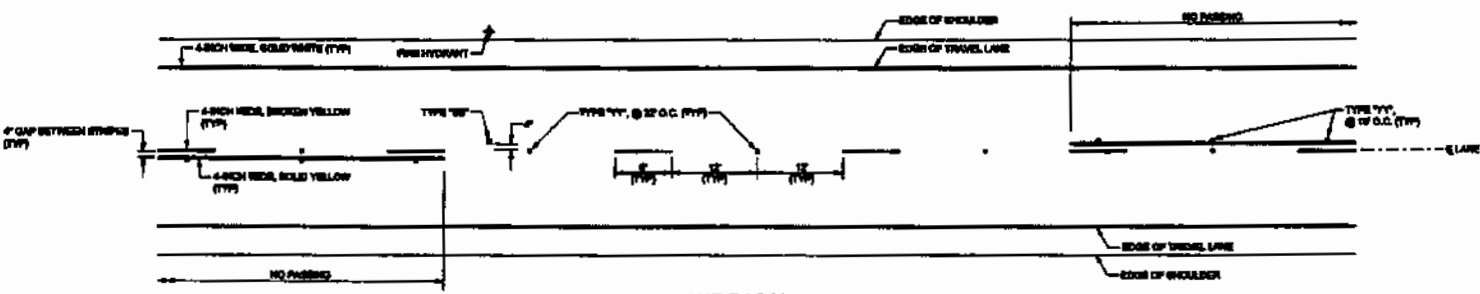

2-LANE PASSING ZONE
NOT TO SCALE

- GENERAL NOTES:**
1. STRIPES SHALL BE THERMOPLASTIC MATERIAL (TYPE 'R).
 2. FOR LANE WIDTH AND MEDIAN WIDTH, REFER TO CONTRACT PLANS.
 3. FOR DETAILS OF PAVED PAVEMENT SURFACES, SEE STD 634-1.

STORED ORIGINAL ON FILE

DRAWING REVISIONS			
NO.	DATE	BY	REVISION



Guam Department of Public Works
 542 North Marine Corps Drive
 Tamuning, Guam 96923
 Tel: (671) 648-8153
 Fax: (671) 648-8176

2 - LANE PAVEMENT MARKING

APPROVED FOR USE ON DPW PROJECTS

[Signature] DATE: 10/14/12

STANDARD NO. 634-02

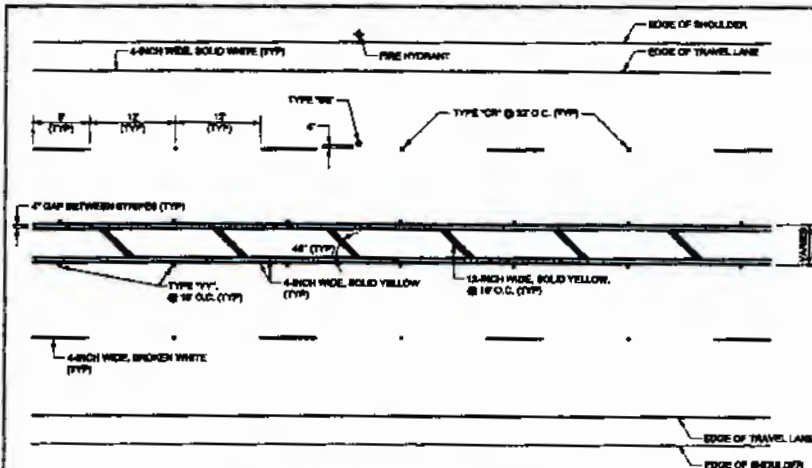

MULTI-LANE WITH STRIPED MEDIAN

NOT TO SCALE

* MEDIAN CONDITION ALSO APPLIES TO 2 LANE COMBINATION

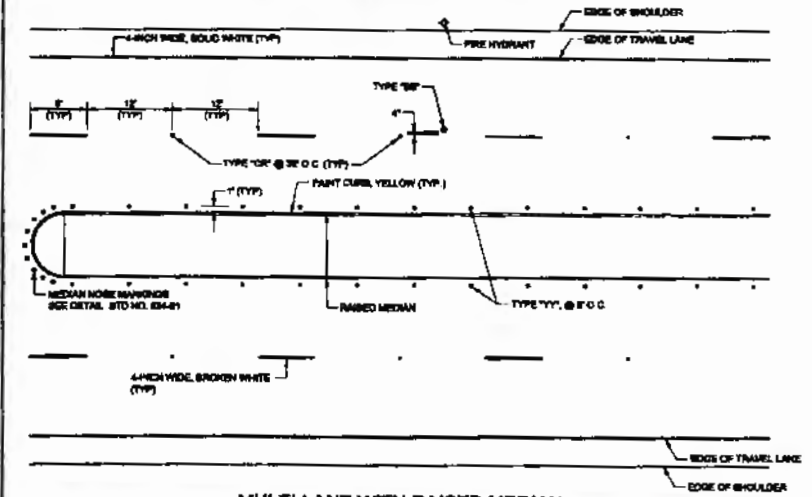

MULTI-LANE WITH RAISED MEDIAN

NOT TO SCALE

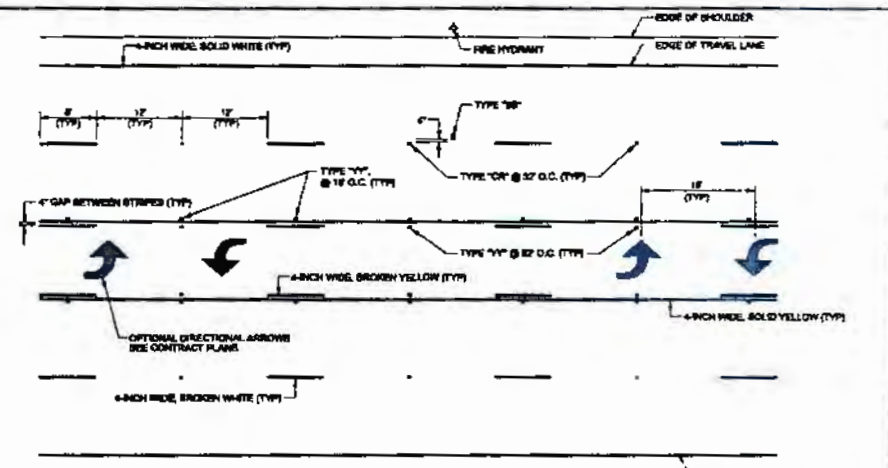

MULTI-LANE WITH CENTER TURNING LANE

NOT TO SCALE

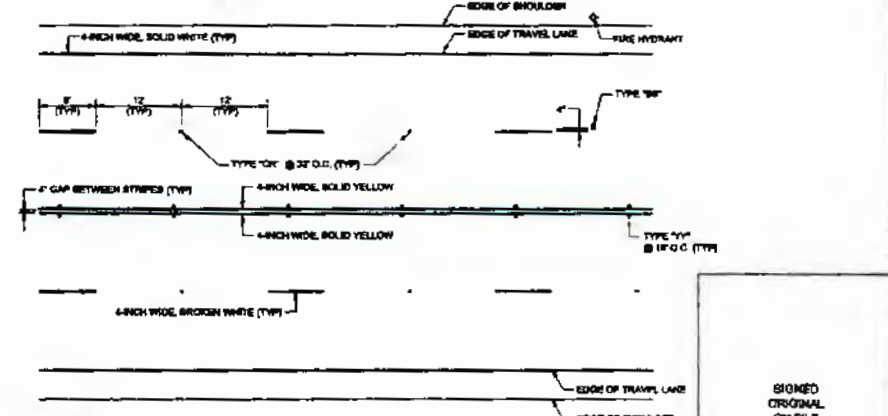

MULTI-LANE WITH DOUBLE CENTERLINES

NOT TO SCALE

GENERAL NOTES:

1. STRIPES SHALL BE THERMOPLASTIC MATERIAL (TYPE H).
2. FOR LANE WIDTH AND MEDIAN WIDTH, REFER TO CONTRACT PLANS.
3. FOR DETAILS OF RAMPED PAVEMENT MARKINGS, SEE STD 834-01

SIGNED ORIGINAL ON FILE

DRAWING REVISIONS			
NO.	DATE	BY	DESCRIPTION



Guam Department of Public Works
 542 North Marthia Corps Drive
 Tamuning, Guam 96913
 Tel: (671) 648-3121
 Fax: (671) 649-6178

MULTI-LANE PAVEMENT MARKING

APPROVED FOR USE ON DPW PROJECTS

[Signature]
 CHIEF ENGINEER, HIGHWAYS
 DEPARTMENT OF PUBLIC WORKS

DATE: 10-14-12

STANDARD NO

834-03

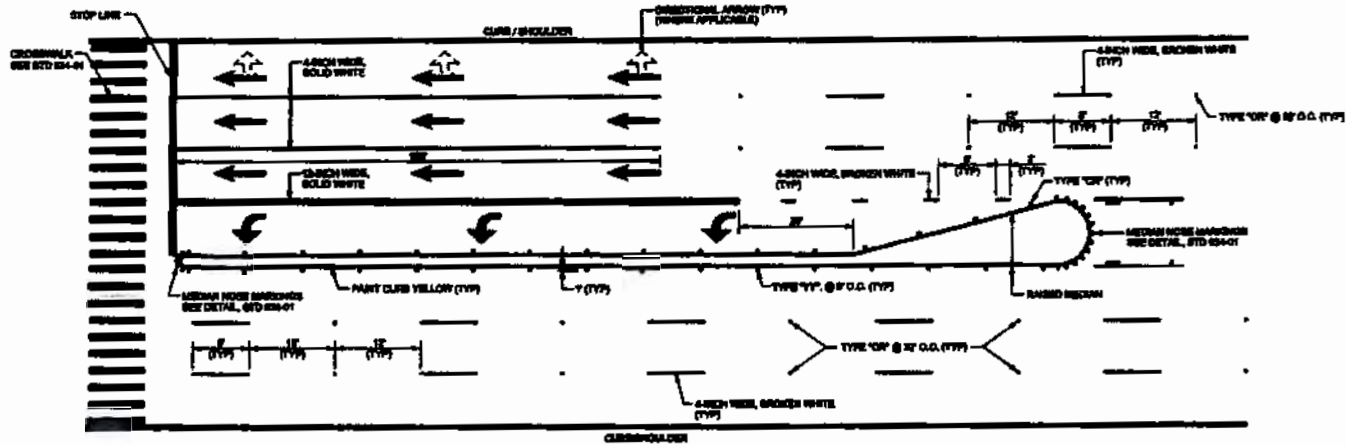

MULTI-LANE INTERSECTION WITH RAISED MEDIAN

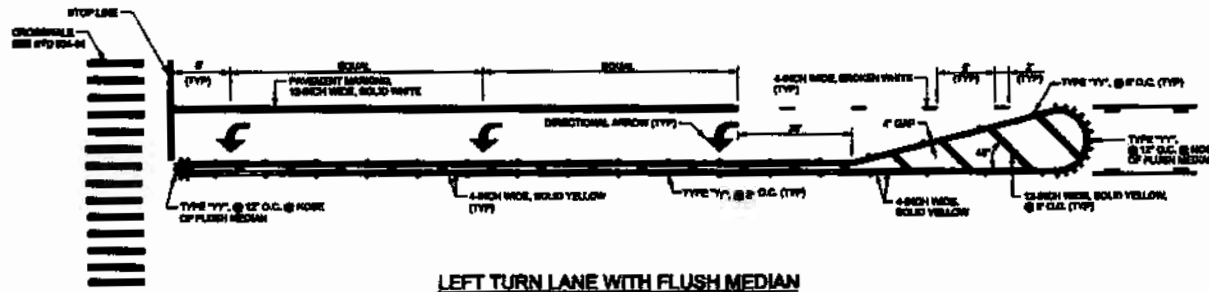

LEFT TURN LANE WITH FLUSH MEDIAN



LANE LINE EXTENSIONS THROUGH INTERSECTIONS

GENERAL NOTES:

1. OTHERS SHALL BE THERMOPLASTIC MATERIAL (TYPE 10).
2. FOR LANE WIDTH AND MEDIAN WIDTH REFER TO CONTRACT PLANS.
3. FOR DETAILS OF PAVED PAVEMENT MARKINGS, SEE STD 884-01.

SEAL
SIGNED
ORIGINAL
ON FILE

DRAWING REVISIONS			
NO.	DATE	BY	DESCRIPTION



State Department of Public Works
542 North Marine Corps Drive
Sacramento, CA 95833
Tel: (916) 646-3131
Fax: (916) 646-4178

**INTERSECTION
PAVEMENT MARKING**

APPROVED FOR USE ON DPW PROJECTS	
<i>[Signature]</i>	DATE: 10-15-13
STANDARD NO.	834-04

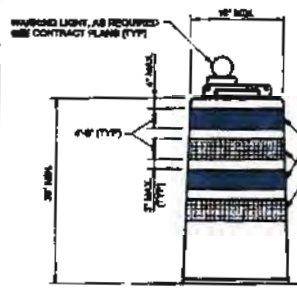

ORANGE TRAFFIC DRUMS

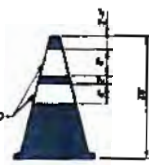

ORANGE CONES

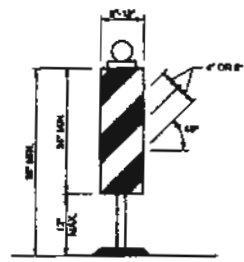

VERTICAL PANEL

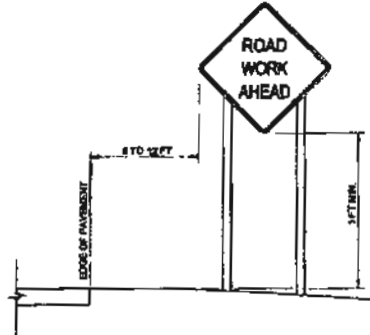

RURAL AREA

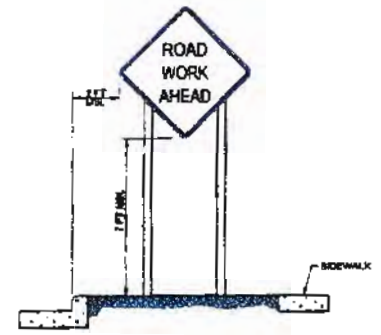

BUSINESS, COMMERCIAL OR RESIDENTIAL AREA

CHANNELIZING DEVICES

TYPICAL SIGN INSTALLATIONS

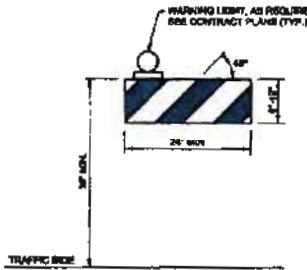

TYPE 1 BARRICADE

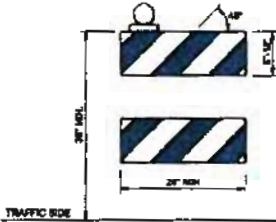

TYPE 2 BARRICADE

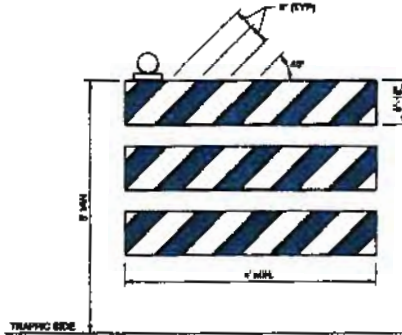

TYPE 3 BARRICADE

TRAFFIC BARRICADES

GENERAL NOTE:

1. ALL WORK ZONE HARDWARE SUCH AS DRUMS, CONES, SIGN SUPPORTS, BARRICADES, AND BARRIERS MUST MEET THE CRASHWORTHY PERFORMANCE CRITERIA IN MOTOR VEHICLE AND SHALL COMPLY WITH THE REQUIREMENTS OF THE CURRENT EDITION OF THE MANUAL ON UNIFORM TRAFFIC CONTROL DEVICES (MUTCD).

SIGNED ORIGINAL ON FILE

NOTES:

1. WARNINGS FOR BARRICADE RAILS SHALL BE RETROREFLECTIVE ORANGE AND WHITE STRIPES SLOPING DOWNWARD AT AN ANGLE OF 45 DEGREES IN THE DIRECTION OF TRAFFIC AS SHOWN.
2. TYPICAL RAIL STRIPE WIDTHS SHALL BE 4 INCHES. 4 INCH WIDE STRIPES MAY BE USED FOR RAIL WIDTHS LESS THAN 36".
3. BARRICADE SUPPORTS ARE NOT SHOWN. SUBMIT PRODUCT INFORMATION INDICATING INCHRA-SQUASH CRASH TESTED AND APPROVED.

DRAWING REVISIONS			
REVISION	DATE	BY	DESCRIPTION



Guam Department of Public Works
 542 North Marine Corps Drive
 Tamuning, Guam 96913
 Tel: (671) 646-3131
 Fax: (671) 649-6176

CHANNELIZING DEVICES AND BARRICADES

APPROVED FOR USE ON DPW PROJECTS

CHIEF ENGINEER, HIGHWAYS
 DEPARTMENT OF PUBLIC WORKS

DATE: 10-14-12

STANDARD NO

635-01

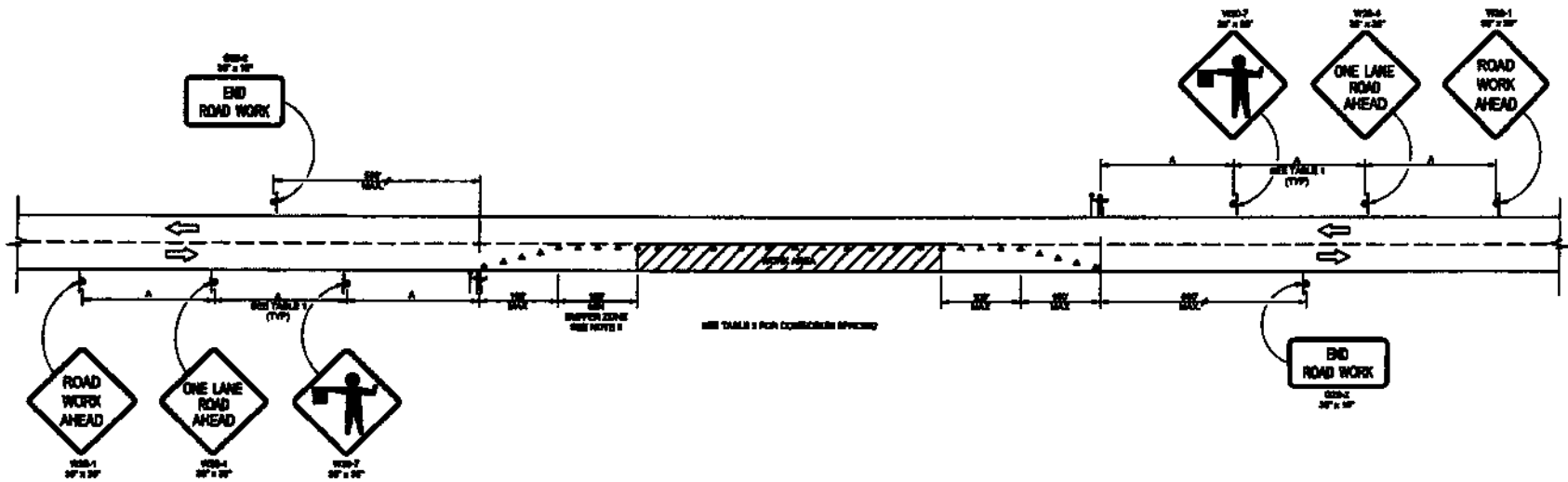

LEGEND:

- WORK AREA
- CHANNELING DEVICE
- FLAGGER WITH STOP/GO PADDLE
- REDUCED OR FLASHER MESSAGE
- TEMPORARY SIGN
- TRAFFIC FLOW

GENERAL NOTES:

1. PAVEMENT MARKINGS FOR TEMPORARY TRAFFIC CONTROL, IF REQUIRED, SHALL BE AS DIRECTED BY THE ENGINEER OR SHOWN IN THE CONTRACT PLANS.
2. THE SIGN LOCATION SPACINGS MAY BE VARIED FROM THE DIMENSIONS SHOWN DUE TO FIELD CONDITIONS INCLUDING ROAD ALIGNMENT, SIGHT DISTANCE, INTERSECTIONS, OBSTRUCTIONS, PERMANENT SIGNS OR OTHER OBSTRUCTIONS.
3. BUFFER ZONE CAN BE INCREASED AS DIRECTED BY THE ENGINEER FOR HORIZONTAL OR VERTICAL CURVES DUE TO SIGHT DISTANCE CONSIDERATION.

SIGNED ORIGINAL ON FILE

TABLE 1

SIGN SPACING	
ROAD TYPE	A (FT)
2 LANE - SPEED 20 MPH OR LESS	100
2 LANE - SPEED 30 MPH OR MORE	200
RURAL	200

TABLE 2

CONCRETE SPACING	
APPROACH SPEED (MPH)	SPACING (FT)
30 & BELOW	20
35	25
40	40

DRAWING REVISIONS

NO.	DATE	BY	DESCRIPTION



Guyana Department of Public Works
 542 North Marine Corps Drive
 Georgetown, Guyana GE6015
 Tel: (592) 642-3111
 Fax: (592) 642-6175

LANE CLOSURE ON TWO LANE HIGHWAY

APPROVED FOR USE ON DPW PROJECTS

[Signature]
 DEPARTMENT OF PUBLIC WORKS

DATE 10-14-12

STANDARD NO.

635-02